

we have the products you need and
the brands you can trust for any
metalworking application

TAYOR[®]
WELDING CONSUMABLES

**ONE-STOP SOLUTION
MORE POWER TO YOU**

**2018
CATALOGUE**

Electrodes
Elektroden
Elektroder
Electrodos
Elettrodi
Hegesztő elektróda
Elektrody
Elekteódy
Электроды
焊条
용접봉
溶接棒

www.tayor-group.com



ISO9001:2008

TAYOR[®]
SHANGHAI TAYOR HEAVY INDUSTRY(GROUP) CO.,LTD.
Add: No.3888 South Shenjiang Road, Tel: +86-021-51372122 69574615
Pudong District, Shanghai (P.C): 201321 Fax: +86-021-51377072
E-mail: exportsales@tayor.cn
www.tayor-group.com



企业概况

SHANGHAI TAYOR HEAVY INDUSTRY GROUP CO.,LTD. was established in the year of 1951,group of integrating the manufacture of welding machine, auto-welding & cutting equipment, welding consumables, welding technology R&D and training school. Taylor welding industry park is the welding equipment consumedly manufacture bases in China.

上海通用重工集团始创于1951年，是集电焊机、焊接与切割自动化装备、焊材制造、焊接技术研究及焊接技术培训为一体的焊接产业集团。通用重工焊接产业园是中国大型的焊接装备制造基地。

Taylor concentrates on welding equipment, cutting equipment and welding consumables as core industry. We have brands of TAYOR, LIKE, SWEC, DONGFENG, YAZI and GOLDEN SHIP, which indicate products of welders, cutters, welding robots and welding consumables.

焊接装备、切割装备、焊接材料是集团的核心产业，旗下运营的品牌有TAYOR、LIKE、SWEC、东风牌、亚字牌和金船牌等，应用于电焊机、切割机、焊接机器人、焊材全系列产品。

By means of global marketing network, the group supplies welding&cutting equipment, welding consumables and technical service for steel structure, heavy equipment, ship manufacturing, aerospace military industry, pipes and pressure vessels, bridge construction, machinery processing, vehicles and rail transit, etc.. Our products are exported to many countries and regions.

集团通过全球营销网络，为钢结构、重型装备、船舶制造、航天军工、管道与压力容器、桥梁与建筑、机械加工、汽车与轨道交通等行业提供焊接装备、切割装备、焊接材料与技术服务。产品畅销全球多个国家和地区。



WELDING CONSUMABLES

焊接材料

- 7-33 ELECTRODES
电焊条
- 35-49 SOLID WIRES
实芯焊丝
- 51-63 TIG RODS
氩弧焊支
- 65-87 FLUX CORED WIRES
药芯焊丝
- 89-99 SUB ARC WIRE AND FLUX
埋弧焊丝及药粉



ELECTRODES

电焊条

- 8-13** MILD STEEL AND IRON POWDER ELECTRODES
低碳钢和铁粉焊条
- 14-17** HYDROGEN CONTROLLED ELECTRODES
低氢焊条
- 18-21** STAINLESS STEEL AND SPECIAL ELECTRODES
不锈钢和特殊焊条
- 22-23** CAST IRON ELECTRODES
铸铁焊条
- 24-25** HARDFACING ELECTRODES
硬面堆焊焊条
- 26-33** PACKAGE
包装

MILD STEEL AND IRON POWDER ELECTRODES

低碳钢和铁粉焊条



ELECTRODES
电焊条

P/N 产品编号	STANDARD 标准	PRODUCT 产品名称	ANALISI CHIMICA 化学成分	SIZE(mm) 直径	TYPE OF CURRENT 电流属性	TYPICAL MACHANICAL PROPERTIES OF ALL-WELD-METAL 力学性能分析				WELDING POSITIONS 焊接位置	APPROVALS 证书
						Y.P N/mm ²	T.S N/mm ²	EL. (%)	I.V J		
A6101YYDXXS	AWS E6013	Alloycraft 4303	C 0.08 Si 0.30 Mn 0.48 P 0.023 S 0.019	2.0-5.0	AC/DC(+)	400	490	31	73 (-20°C)		CCS
A6102YYDXXS	AWS E6013	Alloycraft 6013C	C 0.06 Si 0.30 Mn 0.48 P 0.023 S 0.019	2.0-5.0	AC/DC(+)	400	490	31	73 (-20°C)		CCS ABS BV DNV GL LR
A6103YYDXXS	AWS E6013	Alloycraft 6013	C 0.08 Si 0.30 Mn 0.49 P 0.023 S 0.012	2.0-5.0	AC/DC(+)	415	515	33	90 (0°C)		CCS ABS BV DNV GL LR
A6104YYDXXS	AWS E6013	Alloycraft 6013OK	C 0.08 Si 0.25 Mn 0.51 P 0.023 S 0.013	2.0-5.0	AC/DC(+)	390	485	32	75 (-20°C)		CCS ABS BV DNV GL LR
A6111YYDXXS	AWS E6013	Alloycraft 6013 MS	C 0.06 Si 0.32 Mn 0.43 P 0.025 S 0.006	2.0-5.0	AC/DC(+)	500	405	26	60 (0°C)		CCS ABS BV DNV GL LR
A6105YYDXXS	AWS E6011	Alloycraft 6011	C 0.08 Si 0.37 Mn 0.66 P 0.015 S 0.013	2.4-5.0	AC/DC(+)	410	500	24	50 (-29°C)		ABS, DNV, LR, JIS
A6106YYDXXS	AWS E6010	Alloycraft 6010	C 0.11 Si 0.18 Mn 0.65 P 0.012 S 0.007	2.4-5.0	DC(+)	390	510	28	82 (-30°C)		
A6107YYDXXS	AWS E6019	Alloycraft 6019	C 0.09 Si 0.12 Mn 0.48 P 0.014 S 0.01	2.4-5.0	AC/DC(+)	400	460	34	120 (-29°C)		
A6108YYDXXS	AWS E6024	Alloycraft 6024	C 0.05 Si 0.3 Mn 0.62	2.4-5.0	AC/DC(+)	374	475	27	109(0°C)		

MILD STEEL AND IRON POWDER ELECTRODES

低碳钢和铁粉焊条



P/N 产品编号	STANDARD 标准	PRODUCT 产品名称	ANALISI CHIMICA 化学成分	SIZE(mm) 直径	TYPE OF CURRENT 电流属性	TYPICAL MACHANICAL PROPERTIES OF ALL-WELD-METAL 力学性能分析				WELDING POSITIONS 焊接位置	APPROVALS 证书
						Y.P N/mm ²	T.S N/mm ²	EL. (%)	I.V J		
A6109YYDXXS	AWS E7014	Alloycraft 7014	C 0.08 Si 0.35 Mn 0.80 P 0.015 S 0.01	2.4-5.0	AC/DC(+)	470	550	30	80 (-29°C)		
A6110YYDXXS	AWS E7024	Alloycraft 7024	C 0.08 Si 0.48 Mn 0.90 P 0.023 S 0.011	2.4-5.0	AC/DC(+)	450	575	28	70 (0°C)		

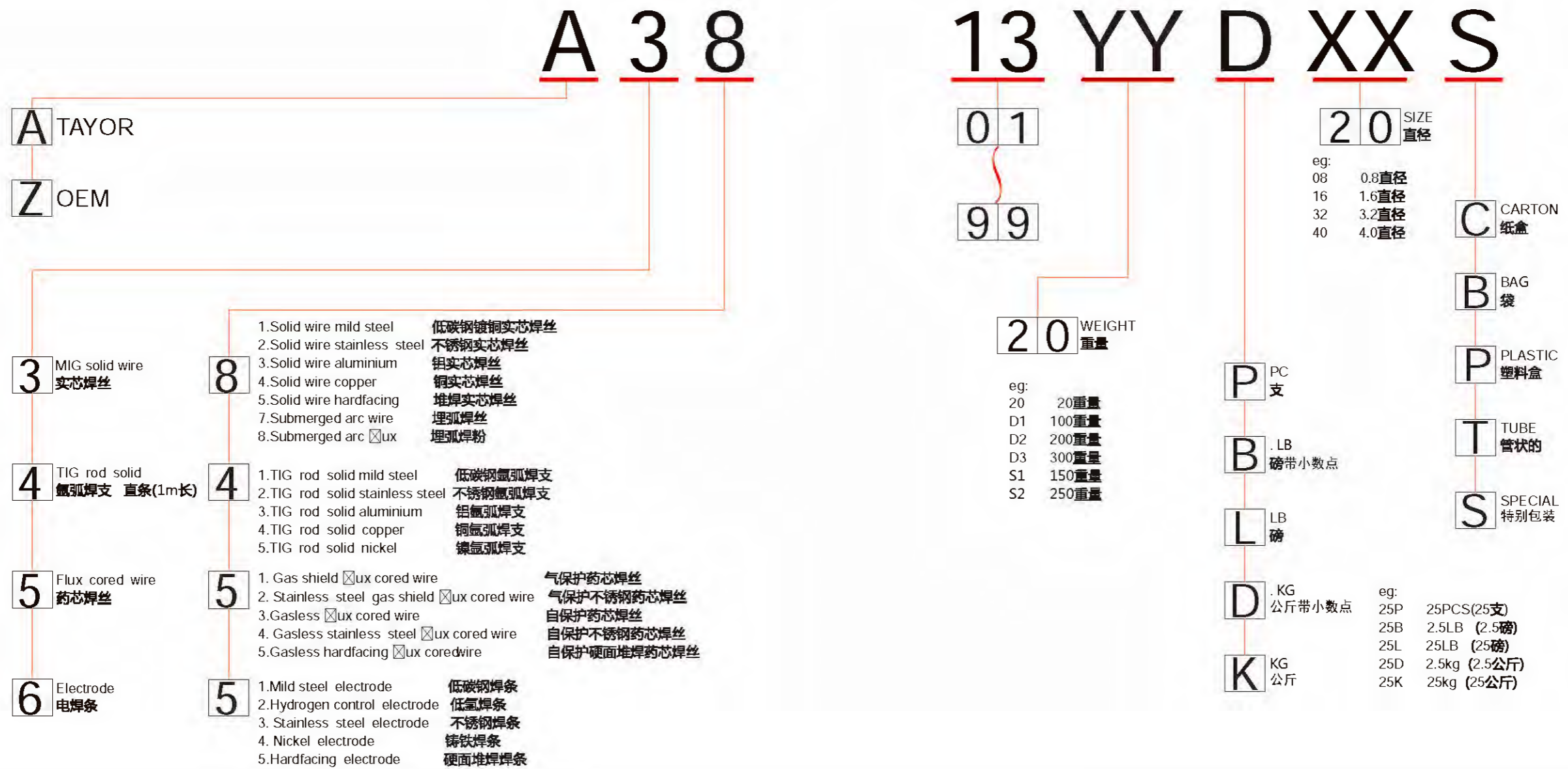

MILD STEEL AND IRON POWDER ELECTRODES

低碳钢和铁粉焊条



P/N 产品编号	STANDARD 标准	PRODUCT 产品名称	ANALISI CHIMICA 化学成分	SIZE(mm) 直径	TYPE OF CURRENT 电流属性	TYPICAL MACHANICAL PROPERTIES OF ALL-WELD-METAL 力学性能分析				WELDING POSITIONS 焊接位置	APPROVALS 证书
						Y.P N/mm ²	T.S N/mm ²	EL. (%)	I.V J		
A6201YYDXXS	AWS E7015	Alloycraft 7015	C 0.08 Si 0.54 Mn 1.2 P 0.019 S 0.009	2.4-5.0	DC(+)	435	540	28	145(-30°C)		CCS ABS BV DNV GL LR
A6202YYDXXS	AWS E7016	Alloycraft 7016	C 0.09 Si 0.38 Mn 1.13 P 0.023 S 0.008	2.4-5.0	AC/DC(+)	445	565	26	152(-30°C)		ABS, DNV, LR, JIS
A6203YYDXXS	AWS E7018	Alloycraft 7018 C	C 0.08 Si 0.57 Mn 1.02 P 0.018 S 0.011	2.4-5.0	AC/DC(+)	465	570	28	160(-30°C)		CCS ABS BV DNV GL LR
A6204YYDXXS	AWS E7018	Alloycraft 7018 OK	C 0.08 Si 0.41 Mn 1.05 P 0.015 S 0.01	2.4-5.0	AC/DC(+)	480	560	32	140(-29°C)		CCS ABS BV DNV GL LR
A6205YYDXXS	AWS E7018-1	Alloycraft 7018-1	C 0.07 Si 0.58 Mn 1.38 Ni 0.2	2.4-5.0	AC/DC(+)	510	590	32	130(-46°C)		
A6206YYDXXS	AWS E7015-G	Alloycraft 7015G	C 0.07 Si 0.45 Mn 1.4 P 0.012 S 0.011	2.4-5.0	DC(+)	435	540	31	130(-40°C)		
A6207YYDXXS	AWS E7018G	Alloycraft 7018G	C 0.08 Si 0.46 Mn 0.74 Ni 0.6 Cr 0.5 Cu 0.4	2.4-5.0	AC/DC(+)	530	620	28	160(0°C)		
A6208YYDXXS	AWS E7018G	Alloycraft 7018G	C 0.06 Si 0.32 Mn 0.90 P 0.018 S 0.015 Ni 1.1 Mo 0.18	2.4-5.0	AC/DC(+)	452	539	29	150(-40°C)		
A6209YYDXXS	AWS E8015G	Alloycraft 8015G	C 0.064 Si 0.36 Mn 0.66 P 0.018 S 0.006 Cr 1.1 M 0.44	2.4-5.0	DC(+)	515	595	25	188 (20°C)		

HYDROGEN CONTROLLED ELECTRODES

低氢焊条



P/N 产品编号	STANDARD 标准	PRODUCT 产品名称	ANALISI CHIMICA 化学成分	SIZE(mm) 直径	TYPE OF CURRENT 电流属性	TYPICAL MACHANICAL PROPERTIES OF ALL-WELD-METAL 力学性能分析				WELDING POSITIONS 焊接位置	APPROVALS 证书
						Y.P N/mm ²	T.S N/mm ²	EL. (%)	I.V J		
A6210YYDXXS	AWS E8018G	Alloycraft 8018G	C 0.08 Si 0.50 Mn 1.02 P 0.014 S 0.01	2.4-5.0	AC/DC(+)	540	600	28	130 (-29°C)		
A6211YYDXXS	AWS E9016G	Alloycraft 9016G	C 0.064 Si 0.33 Mn 1.40 P 0.016 S 0.014 Mo 0.27	2.4-5.0	AC/DC(+)	590	895	24	105 (-30°C)		
A6212YYDXXS	AWS 9016D1	Alloycraft 9016-D1	C 0.08 Si 0.62 Mn 1.55 P 0.024 S 0.009	2.4-5.0	DC(+)	545	645	25	140 (-30°C)		
A6213YYDXXS	AWS E1015G	Alloycraft 1015G	C 0.102 Si 0.42 Mn 1.91 P 0.019 S 0.008 Mo 0.37	2.4-5.0	DC(+)	670	760	23	70 (-30°C)		
A6214YYDXXS	AWS E1015-D2	Alloycraft 1015D2	C 0.073 Si 0.55 Mn 1.8 P 0.025 S 0.008 Ni 0.6 Mo 0.44	2.4-5.0	DC(+)	530	735	24	81 (-30°C)		
A6215YYDXXS	AWS E1015G	Alloycraft 11015G	C 0.07 Si 0.40 Mn 1.85 P 0.016 S 0.012 Mo 0.5	2.4-5.0	DC(+)	680	780	18	100 (20°C)		
A6216YYDXXS	AWS E7015A1	Alloycraft E7015A1	C 0.06 Si 0.20 Mn 0.80 P 0.016 S 0.014 Mo 0.56	2.4-5.0	DC(+)	475	560	29	174 (20°C)		
A6217YYDXXS	AWS E8015B1	Alloycraft 8015B1	C 0.06 Si 0.12 Mn 0.78 P 0.021 S 0.012 Cr 0.6 Mo 0.56	2.4-5.0	DC(+)	505	585	27	157 (20°C)		
A6218YYDXXS	AWS E8015B2	Alloycraft 8015B2	C 0.06 Si 0.32 Mn 0.67 P 0.023 S 0.01 Cr 1.1 Mo 0.53	1.6-5.0	DC(+)	540	620	23	179 (20°C)		

HYDROGEN CONTROLLED ELECTRODES

低氢焊条



P/N 产品编号	STANDARD 标准	PRODUCT 产品名称	ANALISI CHIMICA 化学成分	SIZE(mm) 直径	TYPE OF CURRENT 电流属性	TYPICAL MACHANICAL PROPERTIES OF ALL-WELD-METAL 力学性能分析				WELDING POSITIONS 焊接位置	APPROVALS 证书
						Y.P N/mm ²	T.S N/mm ²	EL. (%)	I.V J		
A6219YYDXXS	AWS E8018C3	Alloycraft 8018C3	C 0.07 Si 0.45 Mn 0.91 Ni 1	1.6-5.0	AC/DC(+)	530	600	31	60 (-40°C)		
A6220YYDXXS	AWS E9015B3	Alloycraft 9015B3	C 0.06 Si 0.23 Mn 0.72 P 0.016 S 0.011 Cr 2.2 Mo 0.95	1.6-5.0	DC(+)	605	690	19	184(20°C)		
A6221YYDXXS	AWS E7018-A1	Alloycraft 7018A1	C 0.068 Si 0.31 Mn 0.69 P 0.016 S 0.009 Mo 0.49	1.6-5.0	DC(+)	450	530	29	220(0°C)		
A6222YYDXXS	AWS E8018B2	Alloycraft 8018B2	C 0.08 Si 0.24 Mn 0.73 P 0.013 S 0.009 Cr 1.3 Mo 0.52	2.4-5.0	DC(+)	540	640	22	170 (0°C)		

ELECTRODES
电焊条

STAINLESS STEEL AND SPECIAL ELECTRODES

不锈钢和特殊焊条



P/N 产品编号	STANDARD 标准	PRODUCT 产品名称	ANALISI CHIMICA 化学成分	SIZE(mm) 直径	TYPE OF CURRENT 电流属性	TYPICAL MECHANICAL PROPERTIES OF ALL-WELD-METAL 力学性能分析				WELDING POSITIONS 焊接位置	APPROVALS 证书
						Y.P N/mm ²	T.S N/mm ²	EL. (%)	I.V J		
A6301YYDXXS	AWS E307-16	Alloycraft 307-16	C 0.09 Si 0.50 Mn 4.25 P 0.01 S 0.01 Ni 9.9 Cr 20 Mo 1	2.0-5.0	AC/DC(+)		600	42			
A6302YYDXXS	AWS E308-15	Alloycraft 308-15	C 0.07 Si 0.33 Mn 1.72 P 0.028 S 0.01 Ni 9.3 Cr 20 Mo 0.03	2.4-5.0	DC(+)		600	44			
A6303YYDXXS	AWS E308-16	Alloycraft 308-16	C 0.05 Si 0.64 Mn 1.43 P 0.028 S 0.008 Ni 9.5 Cr 20 Mo 0.02 Cu 0.1	2.0-5.0	AC/DC(+)		605	45			
A6304YYDXXS	AWS E308L-16	Alloycraft 308L-16	C 0.038 Si 0.64 Mn 1.47 P 0.03 S 0.009 Ni 9.5 Cr 20 Mo 0.04 Cu 0.3	2.0-5.0	AC/DC(+)		540	49			
A6305YYDXXS	AWS E309-15	Alloycraft 309-15	C 0.09 Si 0.44 Mn 1.85 P 0.03 S 0.007 Ni 13 Cr 24 Mo 0.04 Cu 0.2	2.4-5.0	DC(+)		605	39			CCS
A6306YYDXXS	AWS E309-16	Alloycraft 309-16	C 0.07 Si 0.71 Mn 1.89 P 0.03 S 0.01 Ni 12 Cr 24 Mo 0.33 Cu 0.1	2.0-5.0	AC/DC(+)		575	47			
A6307YYDXXS	AWS E309L-16	Alloycraft 309L-16	C 0.04 Si 0.31 Mn 1.53 P 0.025 S 0.01 Ni 12 Cr 24 Mo 0.01 Cu 0.1	2.0-5.0	AC/DC(+)		535	47			
A6308YYDXXS	AWS E309Mo-16	Alloycraft 309Mo-16	C 0.08 Si 0.29 Mn 1.75 P 0.03 S 0.012 Ni 13 Cr 23 Mo 2.24 Cu 0.1	2.0-5.0	AC/DC(+)		600	42			
A6309YYDXXS	AWS E309LMo-16	Alloycraft 309LMo-16	C 0.04 Si 0.32 Mn 1.77 P 0.018 S 0.02 Ni 13 Cr 23 Mo 2.55 Cu 0.1	2.0-5.0	AC/DC(+)		575	35			

STAINLESS STEEL AND SPECIAL ELECTRODES

不锈钢和特殊焊条



P/N 产品编号	STANDARD 标准	PRODUCT 产品名称	ANALISI CHIMICA 化学成分	SIZE(mm) 直径	TYPE OF CURRENT 电流属性	TYPICAL MECHANICAL PROPERTIES OF ALL-WELD-METAL 力学性能分析				WELDING POSITIONS 焊接位置	APPROVALS 证书
						Y.P N/mm ²	T.S N/mm ²	EL. (%)	I.V J		
A6310YYDXXS	AWS E310-16	Alloycraft 310-16	C 0.15 Si 0.39 Mn 1.82 P 0.027 Ni 22 Cr 26 Mo 0.01 Cu 0.2	2.0-5.0	AC/DC(+)		590	36			CCS
A6311YYDXXS	AWS E310LMo-16	Alloycraft 310LMo-16	C 0.08 Si 0.36 Mn 1.89 P 0.027 S 0.012 Ni 21 Cr 26 Mo 2.28 Cu 0.2	2.0-5.0	AC/DC(+)		605	39			
A6312YYDXXS	AWS E312-16	Alloycraft 312-16	C 0.07 Si 0.69 Mn 1.03 P 0.03 S 0.013 Ni 9.5 Cr 30 Mo 0.12 Cu 0.3	2.0-5.0	AC/DC(+)		795	22			
A6313YYDXXS	AWS E316-15	Alloycraft 316-15	C 0.05 Si 0.25 Mn 1.71 P 0.03 S 0.01 Ni 12 Cr 18 Mo 2.2 Cu 0.4	2.4-5.0	DC(+)		550	43			
A314 YYDXXS	AWS E316-16	Alloycraft 316-16	C 0.05 Si 0.47 Mn 1.49 P 0.028 S 0.012 Ni 12 Cr 19 Mo 2.31 Cu 0.1	2.0-5.0	AC/DC(+)		560	49			
A6315YYDXXS	AWS E316L-16	Alloycraft 316L-16	C 0.032 Si 0.68 Mn 1.52 P 0.027 S 0.008	2.0-5.0	AC/DC(+)		540	45			
A6316YYDXXS	AWS E318-16	Alloycraft 318-16	C 0.06 Si 0.40 Mn 1.80 P 0.024 S 0.01	2.0-5.0	AC/DC(+)		610	42			
A6317YYDXXS	AWS E347-16	Alloycraft 347-16	C 0.05 Si 0.67 Mn 1.49 P 0.027 S 0.01	2.0-5.0	AC/DC(+)		630	48			
A6318YYDXXS	AWS E2209-16	Alloycraft 2209-16	C 0.025 Si 0.70 Mn 0.85 P 0.022 S 0.01	2.0-5.0	AC/DC(+)		750	24			

CAST IRON ELECTRODES

铸铁焊条



P/N 产品编号	STANDARD 标准	PRODUCT 产品名称	ANALISI CHIMICA 化学成分	SIZE(mm) 直径	TYPE OF CURRENT 电流属性	TYPICAL MECHANICAL PROPERTIES OF ALL-WELD-METAL 力学性能分析			WELDING POSITIONS 焊接位置	APPROVALS 证书
						Hardness	T.S N/mm ²	EL. (%)		
A6401YYDXXS	AWS Est	Alloycraft Est	C 1.68 Si 0.50 Mn 0.35 P 0.016 S 0.011	2.4-5.0	AC/DC(+)					
A6402YYDXXS	AWS ECI	Alloycraft ECI	C 2.61 Si 3.67 Mn 0.34 P 0.025 S 0.012	2.4-5.0	AC/DC(+)					
A6403YYDXXS	AWS ENiFe-CI	Alloycraft 55	C 0.77 Si 0.31 Mn 0.30 S 0.003 Ni 56	2.4-5.0	AC/DC(+)					
A6404YYDXXS	AWS ENi-CI	Alloycraft 99	C 0.93 Si 0.3 Mn 0.32 S 0.005 Ni 94 Fe 4.23	2.4-5.0	AC/DC(+)					

ELECTRODES
电焊条

HARDFACING ELECTRODES

硬面堆焊条



P/N 产品编号	STANDARD 标准	PRODUCT 产品名称	ANALISI CHIMICA 化学成分	SIZE(mm) 直径	TYPE OF CURRENT 电流属性	TYPICAL MACHANICAL PROPERTIES OF ALL-WELD-METAL 力学性能分析				WELDING POSITIONS 焊接位置	APPROVALS 证书
						Hardness	T.S N/mm²	EL. (%)	I.V J		
A6501YYDXXS	AWS EFeMn-A	Alloycraft HB170A	C 1.05 Si 0.17 Mn 12.93	3.2-5.0	AC/DC(+)						
A6502YYDXXS	AWS EFeMn-A	Alloycraft HB170A	C 1.07 Si 0.13 Mn 14.16 Mo 1.33	3.2-5.0	AC/DC(+)						
A6503YYDXXS		Alloycraft HRC40	C 0.33 Cr 1.9 Mo 0.9	3.2-5.0	AC/DC(+)						
A6504YYDXXS	AWS EFeCr-A1	Alloycraft HRC48	C 3.40 Si 1.67 Mn 3.50 Ni 3.5 Cr 28.9	3.2-5.0	DC(+)						

ELECTRODES
电焊条

PACKAGE 包装

C 2-300

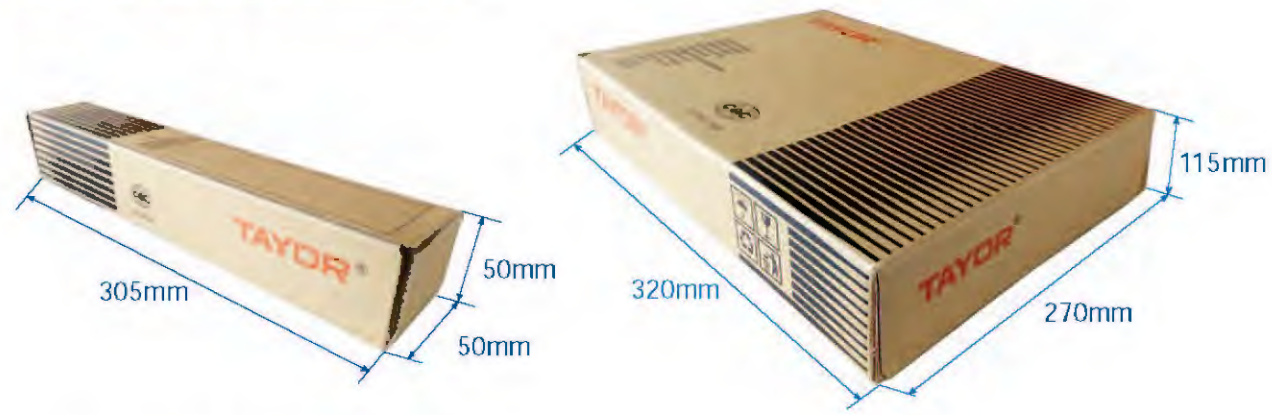

PACKAGE 包装

C 2.5-300

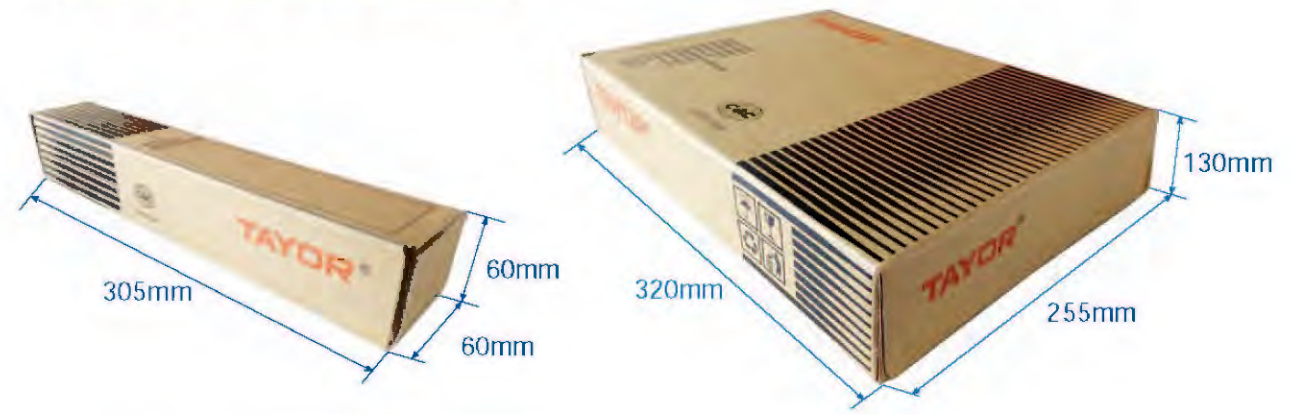

C 2-350



C 2.5-350



C 2-400



C 2.5-400



PACKAGE 包装

C 5-300



C 5-350



C 5-400

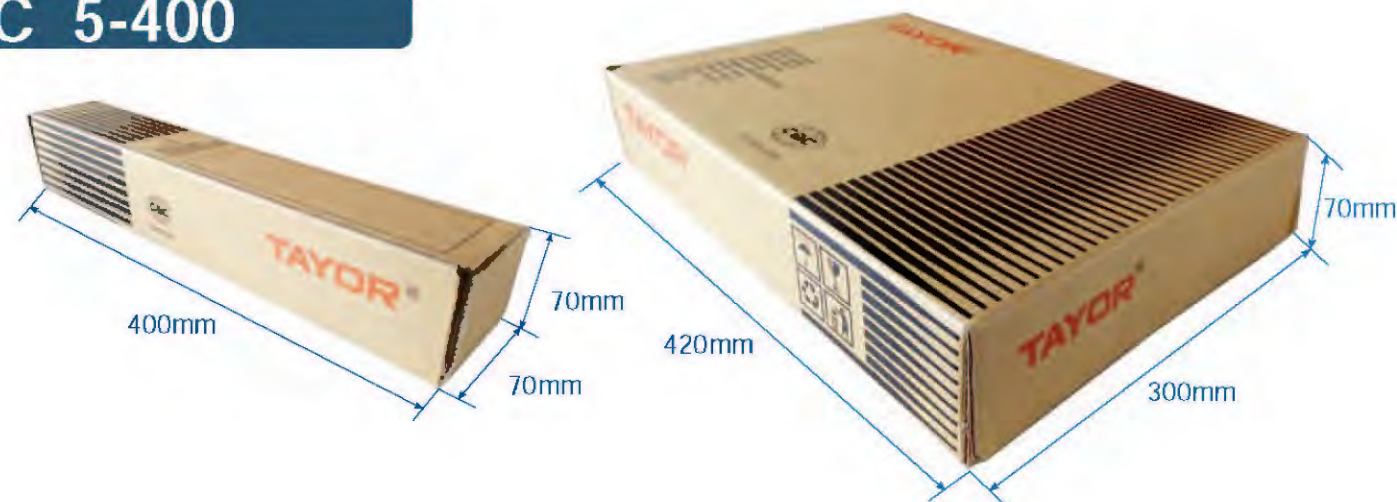

PACKAGE 包装

CVP 5-350

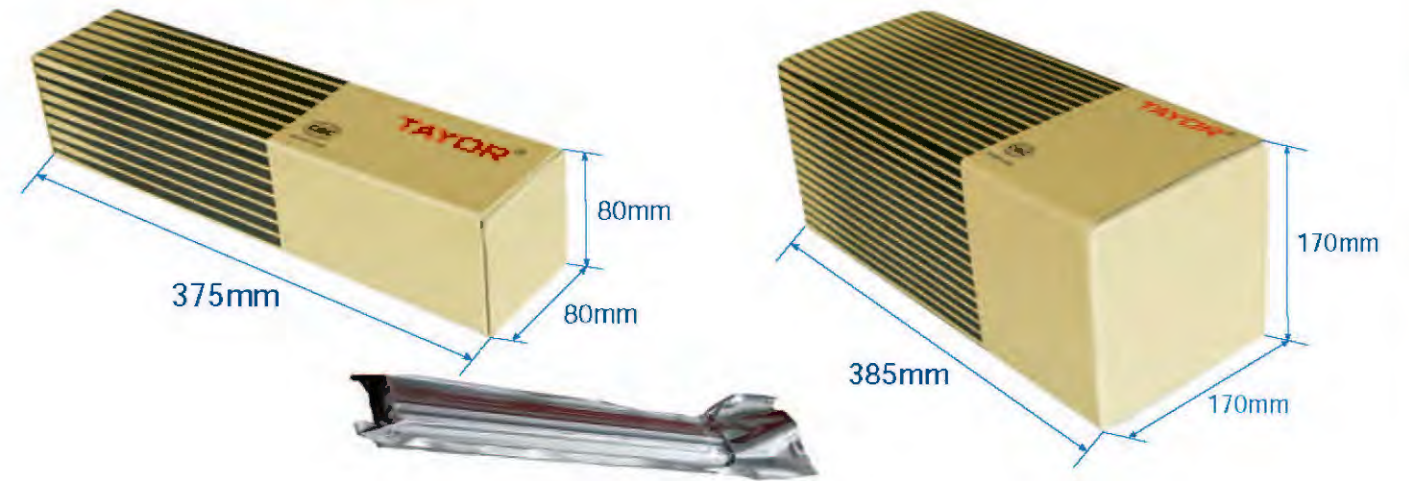

CVP 5-400

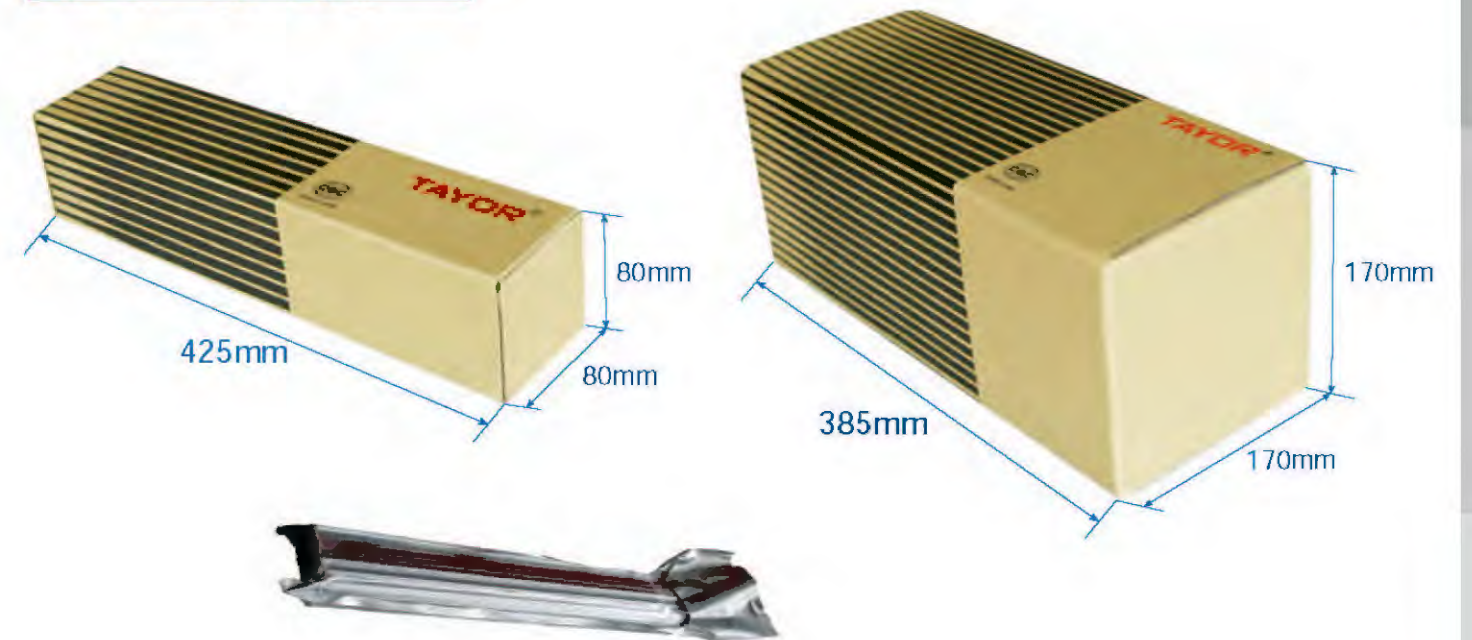

PACKAGE 包装

R 0.5-350

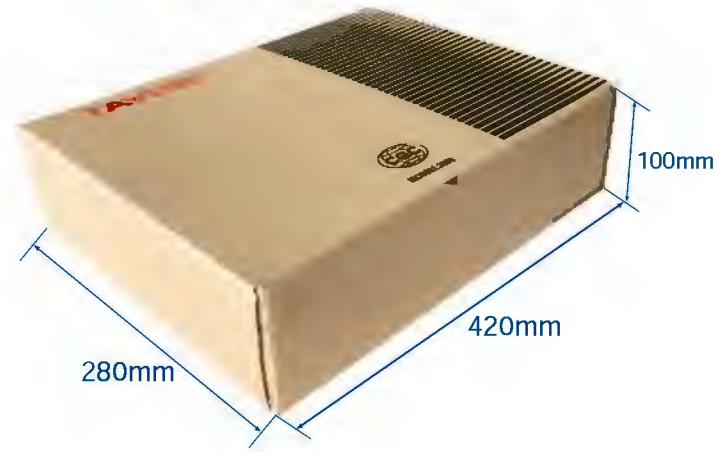

P 0.5-350

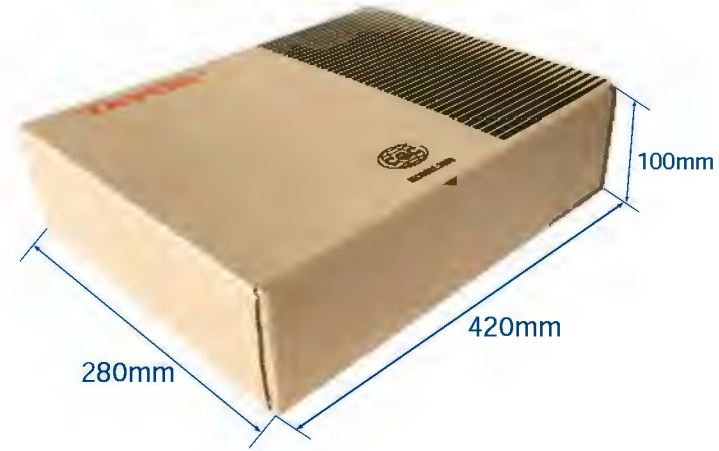
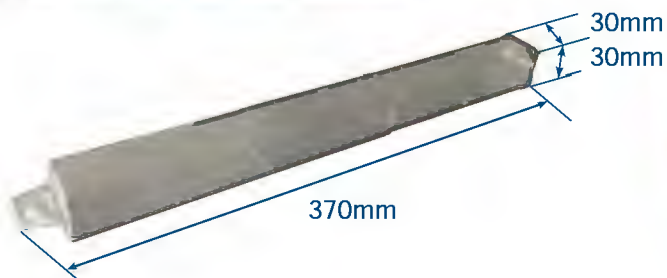

P 1-350

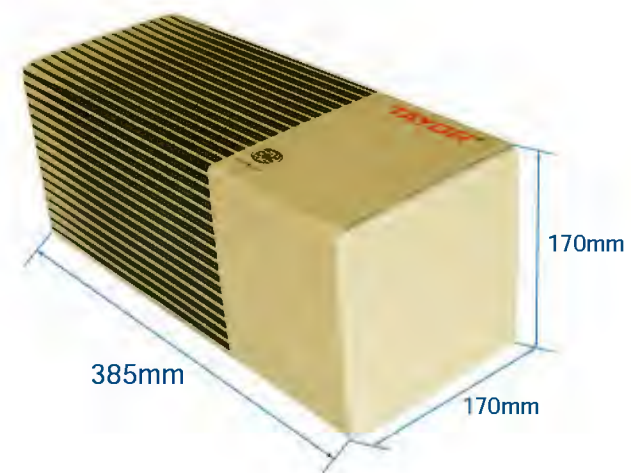
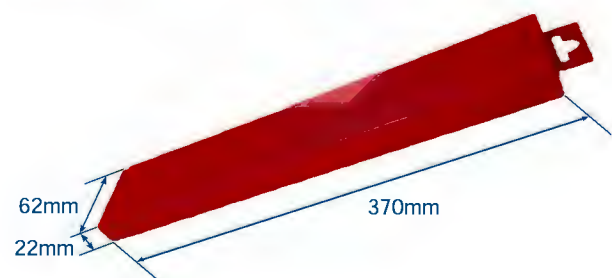

PACKAGE 包装

VP 1-350

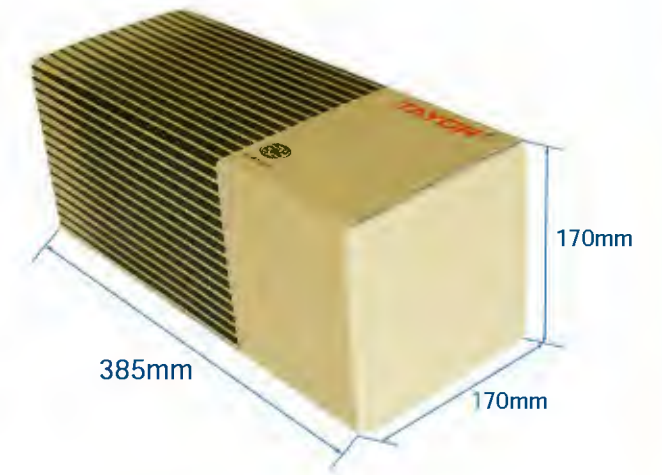
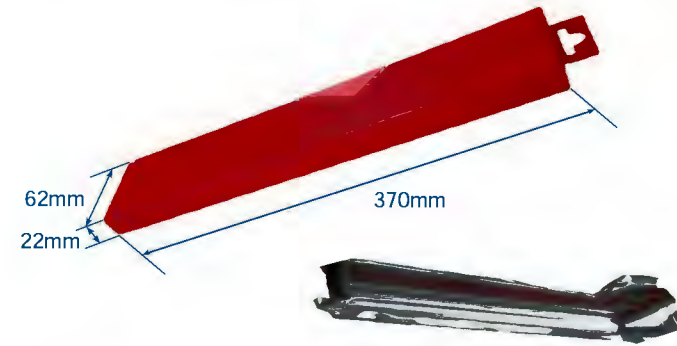

P 2.5-350

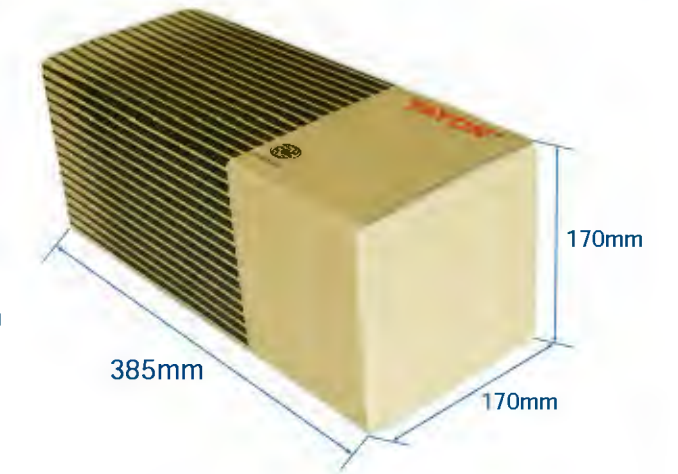
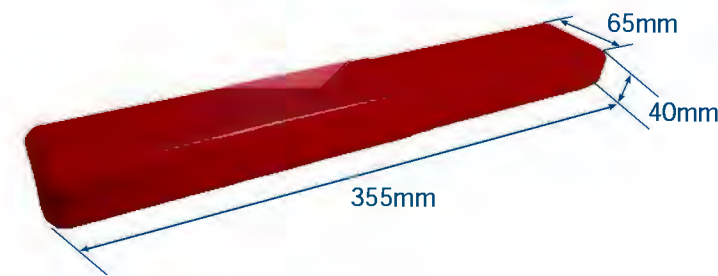

P 2.5-400

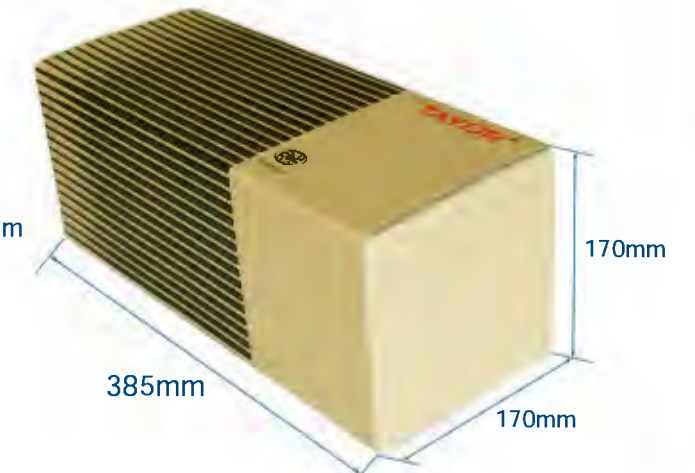
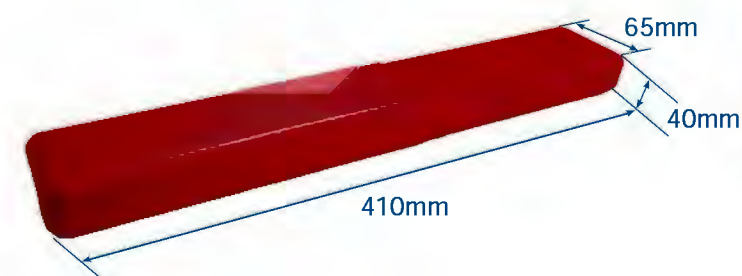

PACKAGE 包装

VP 2.5-350

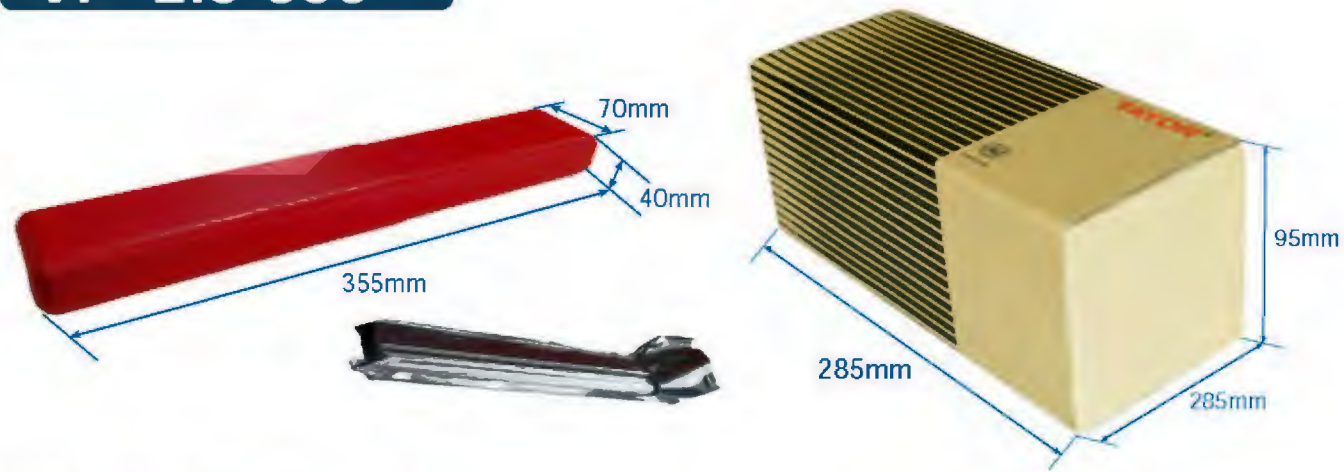

VP 2.5-400

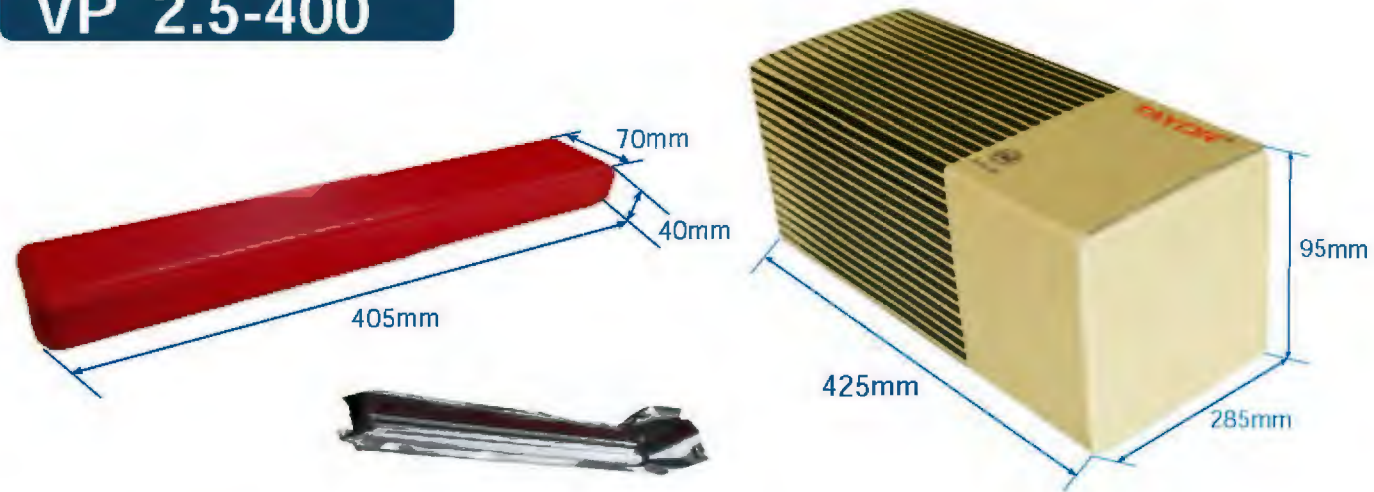

P 5-350

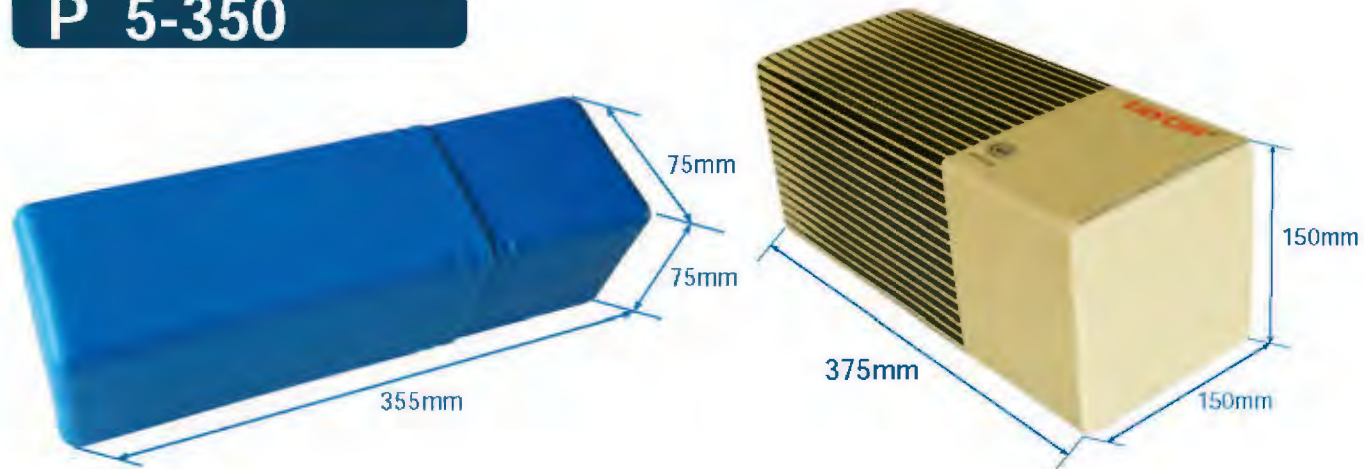

PACKAGE 包装

P 5-400

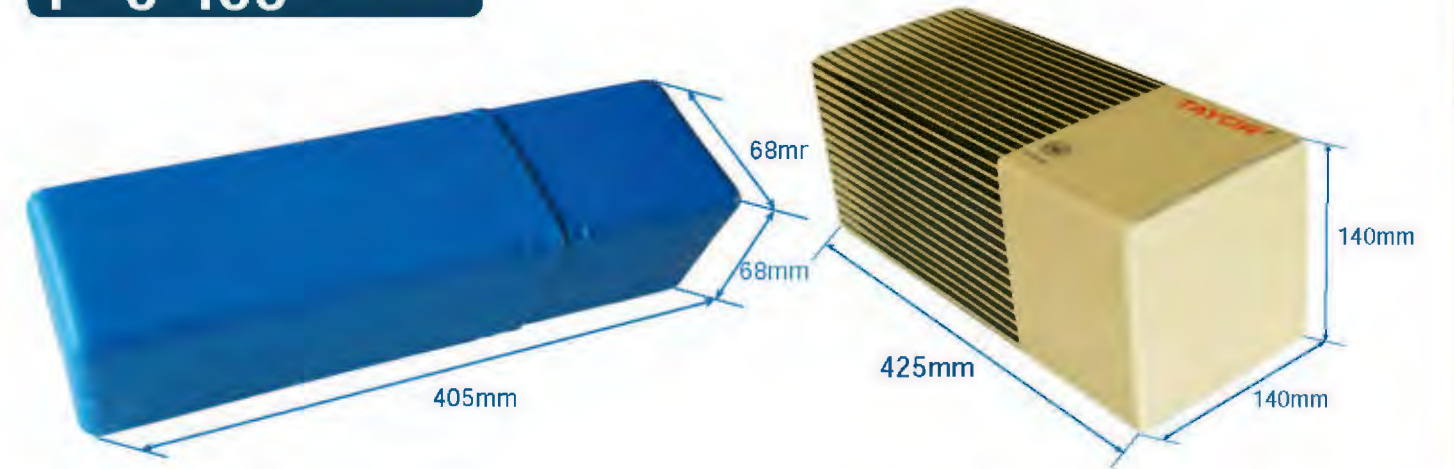

VP 5-350

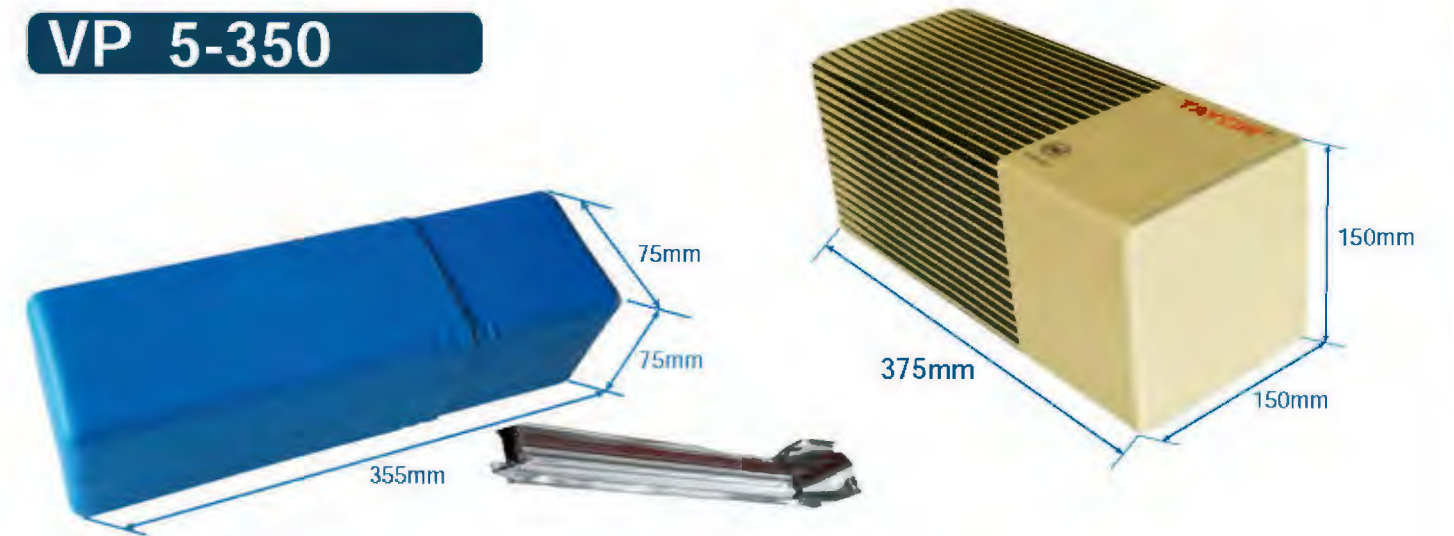

VP 5-400

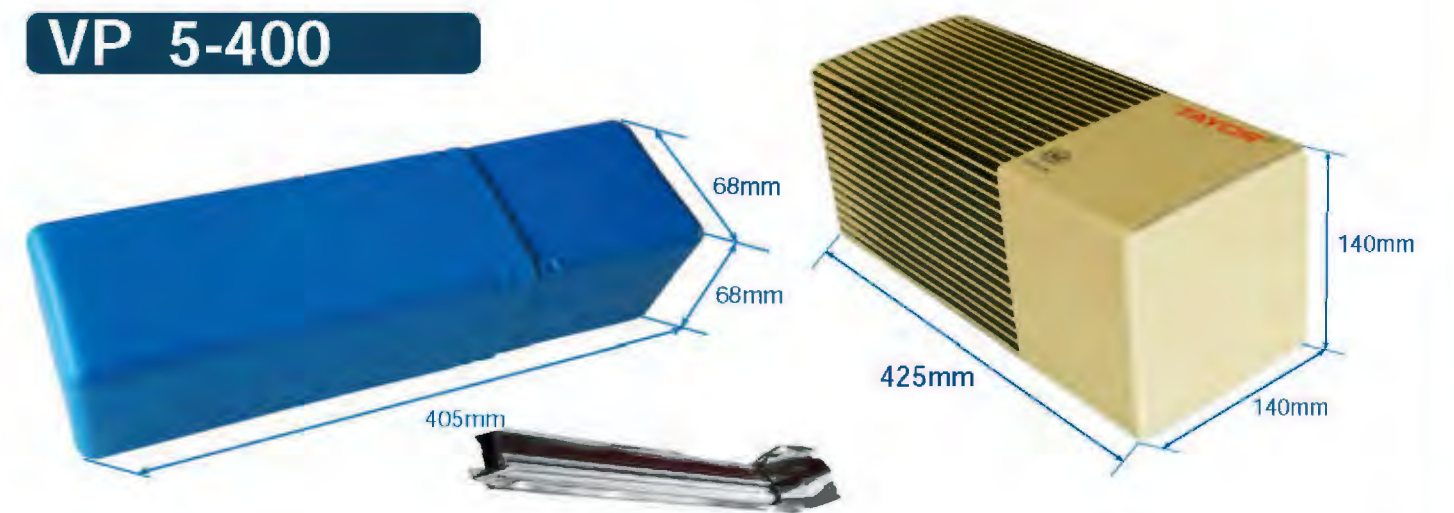



SOLID WIRES

实芯焊丝

- 36-37** GAS METAL ARC WELDING
MIG WIRES (SOLID WIRES)
低碳钢镀铜实芯焊丝

- 38-43** STAINLESS STEELS WELDING
MIG WIRES (SOLID WIRES)
不锈钢实芯焊丝

- 44-45** COPPER AND ALUMINIUM WELDING
MIG WIRES (SOLID WIRES)
铜及铝实芯焊丝

- 46-49** PACKAGE
包装

GAS METAL ARC WELDING MIG WIRES (SOLID WIRES)

低碳钢镀铜实芯焊丝



P/N 产品编号	STANDARD 标准	PRODUCT 产品名称	ANALISI CHIMICA 化学成分	SIZE(mm) 直径	TYPE OF CURRENT 电流属性	TYPICAL MECHANICAL PROPERTIES OF ALL-WELD-METAL 力学性能分析				WELDING POSITIONS 焊接位置	APPROVALS 证书
						Hardness	T.S N/mm ²	EL. (%)	I.V J		
A3101YYDXXS	AWS ER70S-2	Alloycraft 70S-2	C 0.07 Mn 1.18 Si 0.54	0.8-1.6	DC(+)	490	550	29	80 (-29°C)		
A3102YYDXXS	AWS ER70S-3	Alloycraft 70S-3	C 0.07 Mn 1.2 Si 0.67 S 0.011 P 0.015	0.8-1.6	DC(+)	440	540	30	100 (-18°C)		
A3103YYDXXS	AWS ER70S-4	Alloycraft 70S-4	C 0.08 Mn 1.16 Si 0.7 S 0.01 P 0.015	0.8-1.6	DC(+)	420	520	30	110 (-20°C)		
A3104YYDXXS	AWS ER70S-6	Alloycraft 70S-6	C 0.07 Mn 1.53 Si 0.86 S 0.007 P 0.012	0.6-1.6	DC(+)	450	550	30	70 (-29°C)		
A3105YYDXXS	AWS ER70S-G	Alloycraft 70S-G	C 0.06 Mn 1.53 Si 0.80 S 0.01 P 0.014	1.2-1.6	DC(+)	490	560	29	110 (-18°C)		
A3106YYDXXS	AWS ER80S-G	Alloycraft 80S-G	C 0.07 Mn 1.95 Si 0.84	1.2-1.6	AC/DC(+)	550	640	27	110 (-18°C)		
A3107YYDXXS	AWS ER90S-G	Alloycraft 90S-G	C 0.05 Mn 1.82 Si 0.75 S 0.006 P 0.012 Cu 0.2 Mo 0.28	1.2-1.6	AC/DC(+)	580	680	28	80(-40°C)		

SOLID WIRES
实芯焊丝

STAINLESS STEELS WELDING MIG WIRES (SOLID WIRES)

不锈钢实芯焊丝



P/N 产品编号	STANDARD 标准	PRODUCT 产品名称	ANALISI CHIMICA 化学成分	SIZE(mm) 直径	TYPE OF CURRENT 电流属性	TYPICAL MECHANICAL PROPERTIES OF ALL-WELD-METAL 力学性能分析				WELDING POSITIONS 焊接位置	APPROVALS 证书
						Y.P N/mm ²	T.S N/mm ²	EL. (%)	I.V J		
A3201YYDXXS		Alloycraft 1.4370	C 0.08 Mn 7.31 Si 0.68 Ni 9.68 Cr 19.2	0.8-1.6	AC/DC(+)		615	39			
A3202YYDXXS	AWS ER2209	Alloycraft 2209	C 0.015 Mn 1.52 Si 0.49 Ni 8.67 Cr 22.9 Mo 3.12	0.8-1.6	AC/DC(+)		761	36			
A3203YYDXXS	AWS ER307	Alloycraft 307	C 0.08 Mn 4.52 Si 0.46 Ni 9.5 Cr 20 Mo 0.95	0.8-1.6	AC/DC(+)		598	42			
A3204YYDXXS	AWS ER307Si	Alloycraft 307Si	C 0.08 Mn 6.10 Si 0.82 S 0.012 P 0.018 Ni 8.1 Cr 19.2	0.8-1.6	AC/DC(+)	460	610	41			
A3205YYDXXS	AWS ER308	Alloycraft 308	C 0.027 Mn 1.85 Si 0.49 Ni 10.3 Cr 19.9 Mo 0.01	0.8-1.6	AC/DC(+)	450	620	38			
A3206YYDXXS	AWS ER308L	Alloycraft 308L	C 0.02 Mn 2.10 Si 0.50 Ni 9.7 Cr 19.9 Mo 0.03	0.8-1.6	AC/DC(+)	455	640	36.5			
A3207YYDXXS	AWS ER308LSi	Alloycraft 308LSi	C 0.02 Mn 2.25 Si 0.78 Ni 10.5 Cr 19.8 Mo 0.04	0.8-1.6	AC/DC(+)	445	610	41.5			
A3208YYDXXS	AWS ER309	Alloycraft 309	C 0.27 Mn 2.28 Si 0.53 Ni 13.8 Cr 23.6 Mo 0.03	0.8-1.6	AC/DC(+)	465	630	38			
A3209YYDXXS	AWS ER309L	Alloycraft 309L	C 0.011 Mn 2.31 Si 0.588 Ni 14 Cr 23.3 Mo 0.03	0.8-1.6	AC/DC(+)	435	650	39.5			

SOLID WIRES
实芯焊丝

STAINLESS STEELS WELDING MIG WIRES (SOLID WIRES)

不锈钢实芯焊丝



P/N 产品编号	STANDARD 标准	PRODUCT 产品名称	ANALISI CHIMICA 化学成分	SIZE(mm) 直径	TYPE OF CURRENT 电流属性	TYPICAL MACHANICAL PROPERTIES OF ALL-WELD-METAL 力学性能分析				WELDING POSITIONS 焊接位置	APPROVALS 证书
						Y.P N/mm ²	T.S N/mm ²	EL. (%)	I.V J		
A3210YYDXXS	AWS ER309LSi	Alloycraft 309LSi	C 0.011 Mn 1.75 Si 0.86 Ni 13.5 Cr 23.1 Mo 0.02	0.8-1.6	AC/DC(+)	430	600	43			
A3211YYDXXS	AWS ER309LMo	Alloycraft 309LMo	C 0.025 Mn 1.88 Si 0.36 S 0.009 P 0.013 Ni 13.3 Cr 24.4 Mo 2.44	0.8-1.6	AC/DC(+)	440	620	39			
A3212YYDXXS	AWS ER310	Alloycraft 310	C 0.09 Mn 1.45 Si 0.50 Ni 20.8 Cr 25.5 Mo 0.05	0.8-1.6	AC/DC(+)	400	580	35.5			
A3213YYDXXS	AWS ER312	Alloycraft 312	C 0.12 Mn 0.49 Si 1.82 P 0.011 S 0.012 Ni 10.1 Cr 29	0.8-1.6	AC/DC(+)	600	740	25			
A3214YYDXXS	AWS ER316	Alloycraft 316	C 0.05 Mn 1.78 Si 0.36	0.8-1.6	AC/DC(+)		580	38			
A3215YYDXXS	AWS ER316L	Alloycraft 316L	C 0.028 Mn 2.12 Si 0.54 Ni 12 Cr 18.9 Mo 2.16	0.8-1.6	AC/DC(+)	458	585	45.5			
A3218YYDXXS	AWS ER316LSi	Alloycraft 316LSi	C 0.028 Mn 2.05 Si 0.83 Ni 12.9 Cr 18.6 Mo 2.17	0.8-1.6	AC/DC(+)	414	575	40			
A3217YYDXXS	AWS ER317	Alloycraft 317	C 0.036 Mn 1.86 Si 0.45 P 0.009 S 0.012 Ni 14.2 Cr 19.4 Mo 3.45	0.8-1.6	AC/DC(+)	470	600	472			
A3218YYDXXS	AWS ER321	Alloycraft 321	C 0.06 Mn 1.64 Si 0.56 Ni 9.33 Cr 19.4 Mo 0.15	0.8-1.6	AC/DC(+)		640	37			

SOLID WIRES
实芯焊丝

STAINLESS STEELS WELDING MIG WIRES (SOLID WIRES)

不锈钢实芯焊丝



P/N 产品编号	STANDARD 标准	PRODUCT 产品名称	ANALISI CHIMICA 化学成分	SIZE(mm) 直径	TYPE OF CURRENT 电流属性	TYPICAL MACHANICAL PROPERTIES OF ALL-WELD-METAL 力学性能分析				WELDING POSITIONS 焊接位置	APPROVALS 证书
						Y.P N/mm ²	T.S N/mm ²	EL. (%)	I.V J		
A3219YYDXXS	AWS ER347	Alloycraft 347	C 0.04 Mn 1.81 Si 0.41 Ni 9.9 Cr 20.4 Mo 0.07	0.8-1.6	DC(+)		620	41			
A3220YYDXXS	AWS ER410	Alloycraft 410	C 0.112 Mn 0.46 Si 0.34 P 0.009 S 0.013 Cr 11.8	0.8-1.6	DC(+)	390	570	25			
A3221YYDXXS	AWS ER430	Alloycraft 430	C 0.052 Mn 0.31 Si 0.36 Ni 0.15 Cr 16.2 Mo 0.01	0.8-1.6	DC(+)		533	28			
A3222YYDXXS	AWS ER430LNb	Alloycraft 430LNb	C 0.01 Mn 0.46 Si 0.49 Ni 0.2 Cr 18.5 Mo Na+T	0.8-1.6	DC(+)		48.1	45			
A3223YYDXXS		Alloycraft 304	C 0.055 Mn 1.37 Si 0.64 Cu 0.2 Ni 8.06 Cr 18.5 Mo 0.16	0.8-1.6	DC(+)						

SOLID WIRES
实芯焊丝

COPPER AND ALUMINIUM WELDING MIG WIRES (SOLID WIRES)

铜及铝实芯焊丝



P/N 产品编号	STANDARD 标准	PRODUCT 产品名称	ANALISI CHIMICA 化学成分	SIZE(mm) 直径	TYPE OF CURRENT 电流属性	TYPICAL MACHANICAL PROPERTIES OF ALL-WELD-METAL 力学性能分析				WELDING POSITIONS 焊接位置	APPROVALS 证书
						Y.P N/mm ²	T.S N/mm ²	EL. (%)	I.V J		
A3401YYDXXS	AWS ERCuSi-A	Alloycraft B8	Fe 0.25 Si 3.40 Mn 1.00 P 0.00 Sn 0.90 Cu Bal Zn 0.9	1.0-1.6	DC(+)		380	50			
A3402YYDXXS	AWS ERCu	Alloycraft B10	Si 0.50 Mn 0.50 P 0.15 Sn 1.00 Cu 98	1.0-1.6	DC(+)		200	30			
P/N 产品编号	STANDARD 标准	PRODUCT 产品名称	ANALISI CHIMICA 化学成分	SIZE(mm) 直径	TYPE OF CURRENT 电流属性	TYPICAL MACHANICAL PROPERTIES OF ALL-WELD-METAL 力学性能分析				POSIZIONI DI SALDATURA 焊接位置	APPROVALS 证书
						Y.P N/mm ²	T.S N/mm ²	EL. (%)	I.V J		
A3301YYDXXS	AWS ER4043	Alloycraft 4043	Fe 0.8 Si 4.5-6 Mn 0.05 Cu 0.30 Mg 0.05 Zn 0.1 Ti 0.2 Al Bala	0.8-1.6	AC/DC(+)		186		8		
A3302YYDXXS	AWS ER5356	Alloycraft 5356	Fe 0.4 Si 0.25 Mn 0.05-0.2 Cu 0.10 Mg 4.5-5.5 Zn 0.1 Ti 0.05-0.2 Cr 0.05-0.2 Al Bala	0.8-1.6	AC/DC(+)		260		17		
A3303YYDXXS	AWS ER5183	Alloycraft 5183	Fe 0.40 Si 0.40 Mn 0.5-1 Cu 0.10 Mg 4.3-5.2 Zn 0.3 Ti 0.15 Cr 0.05-0.25 Al Bala	0.8-1.6	AC/DC(+)		297	16			

SOLID WIRES
实芯焊丝

PACKAGE 包装

D 100

Plastic - 塑料

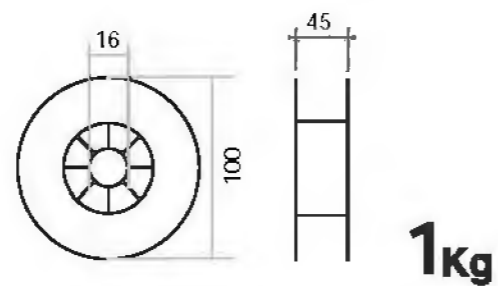

D 200

Plastic - 塑料

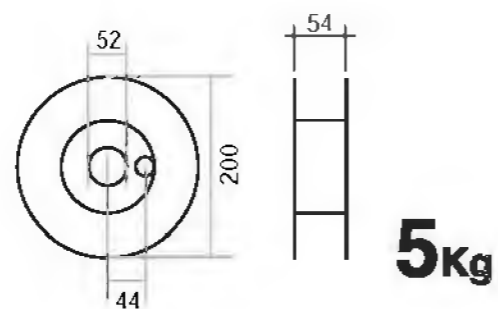

D 250

Plastic - 塑料

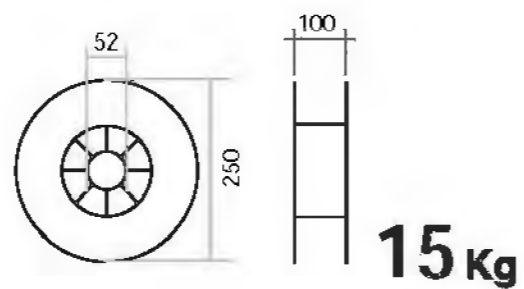

PACKAGE 包装

D 270

Plastic - 塑料

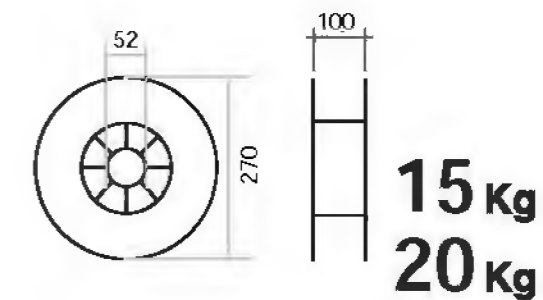

D 300

Plastic - 塑料

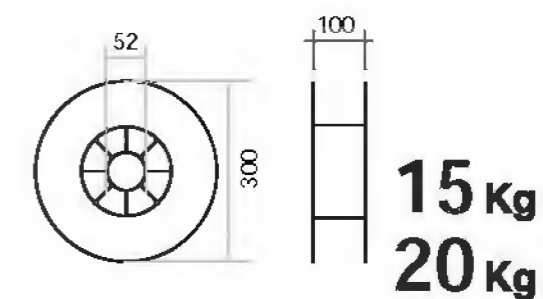

D 300W

Plastic - 塑料

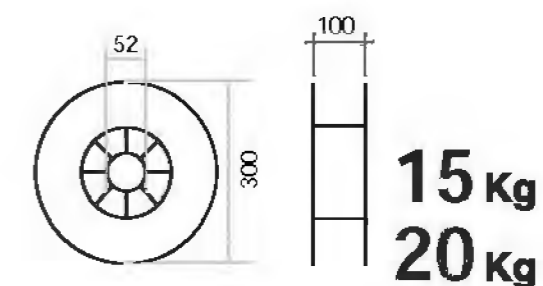

PACKAGE 包装

D 100

Plastic - 塑料

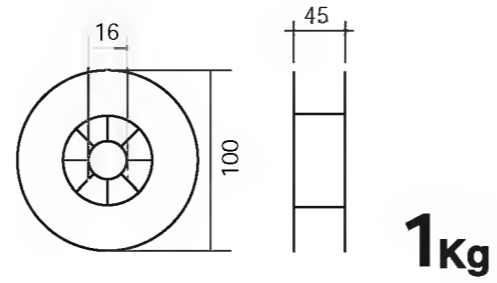

1Kg

D 200

Plastic - 塑料

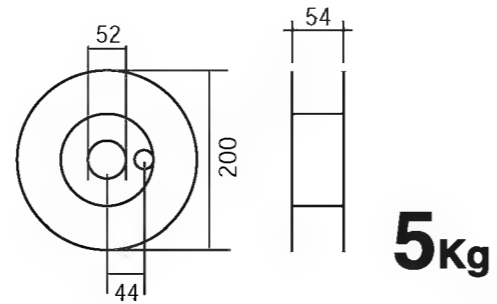

5Kg

D 250

Plastic - 塑料

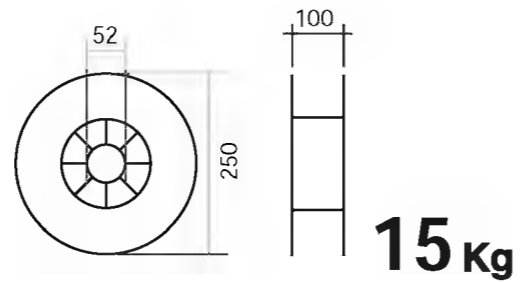

15Kg

PACKAGE 包装

D 270

Plastic - 塑料

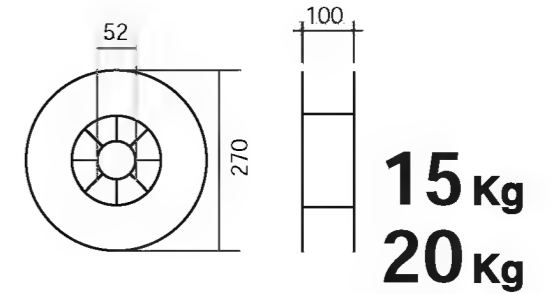

**15Kg
20Kg**

D 300

Plastic - 塑料

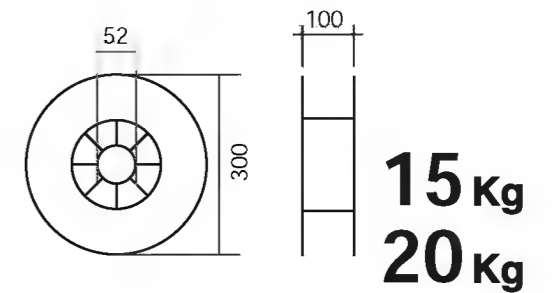

**15Kg
20Kg**

D 300W

Plastic - 塑料

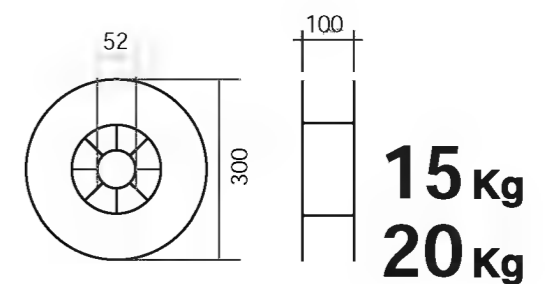

**15Kg
20Kg**

PACKAGE 包装

K 300S

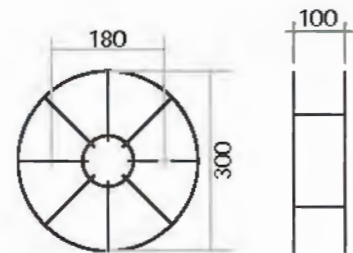
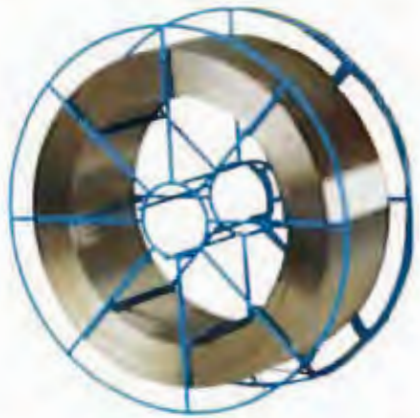

15Kg

K 300

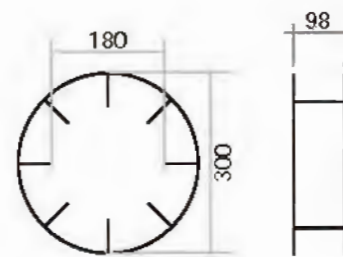

15Kg
18Kg
20Kg

D ADAPTOR

Ferro - 塑料



PACKAGE 包装

DRUM 100



100 kg

DRUM 250

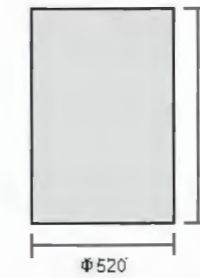

250 kg

DRUM 300



300 kg



TIG RODS

氩弧焊支

- | | |
|-------|---|
| 52-53 | MILD STEEL
TIG WELDING RODS
镀铜实芯氩弧焊支 |
| 54-59 | STAINLESS STEELS
TIG WELDING RODS
不锈钢实芯氩弧焊支 |
| 60-61 | COPPER AND ALUMINIUM
TIG WELDING RODS
铜及铝实芯氩弧焊支 |
| 62-63 | PACKAGE
包装 |

MILD STEEL TIG WELDING RODS
镀铜实芯氩弧焊支

P/N 产品编号	STANDARD 标准	PRODUCT 产品名称	ANALISI CHIMICA 化学成分	SIZE(mm) 直径	TYPE OF CURRENT 电流属性	TYPICAL MACHANICAL PROPERTIES OF ALL-WELD-METAL 力学性能分析				WELDING POSITIONS 焊接位置	APPROVALS 证书
						Y.P N/mm ²	T.S N/mm ²	EL. (%)	I.V J		
A4101YYDXXS	AWS ER70S-2	Alloycraft 70S-2	C 0.06 Si 0.49 Mn 1.11 S 0.008 P 0.015	1.2-4.0 (L= 1000mm)	DC(-)	450	535	29	180 (-30°C)		
A4102YYDXXS	AWS ER70S-3	Alloycraft 70S-3	C 0.081 Si 0.61 Mn 1.32 S 0.012 P 0.015	1.2-4.0 (L= 1000mm)	DC(-)	440	540	29	156 (-20°C)		
A4103YYDXXS	AWS ER70S-4	Alloycraft 70S-4	C 0.071 Si 0.80 Mn 1.45 P 0.01 S 0.015	1.2-4.0 (L= 1000mm)	DC(-)	460	560	28	108 (-20°C)		
A4104YYDXXS	AWS ER70S-6	Alloycraft 70S-6	C 0.07 Si 0.83 Mn 1.48 S 0.015 P 0.015	1.2-4.0 (L= 1000mm)	DC(-)	460	550	30	160 (-30°C)		
A4105YYDXXS	AWS ER70S-G	Alloycraft 70S-G	C 0.07 Si 0.83 Mn 1.48 S 0.015 P 0.015	1.2-4.0 (L= 1000mm)	DC(-)	460	550	30	160 (-30°C)		
A4106YYDXXS	AWS ER80S-G	Alloycraft 80S-G	C 0.08 Si 0.68 Mn 1.38 S 0.008 P 0.014 Cr 1.1 Mo 0.53	1.2-4.0 (L= 1000mm)	DC(-)	495	635	28	200(20°C)		
A4107YYDXXS	AWS ER90S-G	Alloycraft 90S-G	C 0.086 Si 0.60 Mn 0.77 S 0.013 P 0.019	1.2-4.0 (L= 1000mm)	DC(-)	600	690	23	180(-20°C)		

STAINLESS STEELS TIG WELDING RODS

不锈钢实芯氩弧焊支



P/N 产品编号	STANDARD 标准	PRODUCT 产品名称	ANALISI CHIMICA 化学成分	SIZE(mm) 直径	TYPE OF CURRENT 电流属性	TYPICAL MECHANICAL PROPERTIES OF ALL-WELD-METAL 力学性能分析				WELDING POSITIONS 焊接位置	APPROVALS 证书
						Y.P N/mm ²	T.S N/mm ²	EL. (%)	I.V J		
A4201YYDXXS		Alloycraft 1.4370	C 0.08 Si 0.68 Mn 7.31 Ni 9.68 Cr 19.2	1.2-4.0 (L= 1000mm)	DC(-)		615	39			
A4202YYDXXS	AWS ER2209	Alloycraft 2209	C 0.015 Si 0.49 Mn 1.52 Ni 8.67 Cr 22.94 Mo 3.1	1.2-4.0 (L= 1000mm)	DC(-)	625	790	35			
A4203YYDXXS	AWS ER307	Alloycraft 307	C 0.08 Si 0.46 Mn 4.52 Ni 9.5 Cr 20 Mo 0.95	1.2-4.0 (L= 1000mm)	DC(-)		598	42			
A4204YYDXXS	AWS ER307Si	Alloycraft 307Si	C 0.06 Si 0.41 Mn 6.20 Ni 8.1 Cr 19.3	1.2-4.0 (L= 1000mm)	DC(-)	480	610	41			
A4205YYDXXS	AWS ER308	Alloycraft 208	C 0.34 Si 0.49 Mn 1.52 Ni 10.3 Cr 19.9 Mo 0.03	1.2-4.0 (L= 1000mm)	DC(-)	450	620	40			
A4206YYDXXS	AWS ER308L	Alloycraft 308L	C 0.02 Si 0.50 Mn 2.10 Ni 10.3 Cr 19.9 Mo 0.03	1.2-4.0 (L= 1000mm)	DC(-)	455	600	41			
A4207YYDXXS	AWS ER308LSi	Alloycraft 308LSi	C 0.02 Si 0.78 Mn 2.25 Ni 10.5 Cr 19.8 Mo 0.02	1.2-4.0 (L= 1000mm)	DC(-)	445	585	40			
A4208YYDXXS	AWS ER309	Alloycraft 309	C 0.043 Si 0.46 Mn 1.75 Ni 12.5 Cr 23.62 Mo 0.026	1.2-4.0 (L= 1000mm)	DC(-)	460	600	38			

STAINLESS STEELS TIG WELDING RODS

不锈钢实芯氩弧焊支



P/N 产品编号	STANDARD 标准	PRODUCT 产品名称	ANALISI CHIMICA 化学成分	SIZE(mm) 直径	TYPE OF CURRENT 电流属性	TYPICAL MECHANICAL PROPERTIES OF ALL-WELD-METAL 力学性能分析				WELDING POSITIONS 焊接位置	APPROVALS 证书
						Y.P N/mm ²	T.S N/mm ²	EL. (%)	I.V J		
A4209YYDXXS	AWS ER309L	Alloycraft 309L	C 0.025 Si 0.58 Mn 2.22 Ni 13.7 Cr 23.32 Mo 0.026	1.2-4.0 (L= 1000mm)	DC(-)	445	595	39			CCS
A4210YYDXXS	AWS ER309LSi	Alloycraft 309LSi	C 0.019 Si 0.86 Mn 1.75 Ni 13.5 Cr 23.27 Mo 0.017	1.2-4.0 (L= 1000mm)	DC(-)	450	610	40			
A4211YYDXXS	AWS ER309LMo	Alloycraft 309LMo	C 0.09 Si 0.46 Mn 1.82 Ni 13.1 Cr 23.8 Mo 2.54	1.2-4.0 (L= 1000mm)	DC(-)	440	620	42			
A4212YYDXXS	AWS ER310	Alloycraft 310	C 0.095 Si 0.50 Mn 1.68 Ni 20.8 Cr 25.5 Mo 0.05	1.2-4.0 (L= 1000mm)	DC(-)		580	34			
A4213YYDXXS	AWS ER312	Alloycraft 312	C 0.13 Si 0.49 Mn 1.62 Ni 20.8 Cr 25.5 Mo 0.05	1.2-4.0 (L= 1000mm)	DC(-)	590	710	26			
A4214YYDXXS	AWS ER316	Alloycraft 316	C 0.03 Si 0.39 Mn 1.78 Ni 12.5 Cr 18.6 Mo 2.25	1.2-4.0 (L= 1000mm)	DC(-)	460	590	38			
A4215YYDXXS	AWS ER316L	Alloycraft 316L	C 0.022 Si 0.54 Mn 1.97 Ni 12 Cr 18.9 Mo 2.16	1.2-4.0 (L= 1000mm)	DC(-)	455	570	38			
A4216YYDXXS	AWS ER316LSi	Alloycraft 316LSi	C 0.02 Si 0.74 Mn 1.60 Ni 12.4 Cr 19 Mo 2.3	1.2-4.0 (L= 1000mm)	DC(-)	380	550	39			
A4217YYDXXS	AWS ER317	Alloycraft 317	C 0.04 Si 0.45 Mn 1.86 Ni 14.2 Cr 19.4 Mo 3.5	1.2-4.0 (L= 1000mm)	DC(-)	470	600	42			

TIG RODS
氩弧焊支

STAINLESS STEELS TIG WELDING RODS

不锈钢实芯氩弧焊支



P/N 产品编号	STANDARD 标准	PRODUCT 产品名称	ANALISI CHIMICA 化学成分	SIZE(mm) 直径	TYPE OF CURRENT 电流属性	TYPICAL MECHANICAL PROPERTIES OF ALL-WELD-METAL 力学性能分析				WELDING POSITIONS 焊接位置	APPROVALS 证书
						Y.P N/mm ²	T.S N/mm ²	EL. (%)	I.V J		
A4218YYDXXS	AWS ER321	Alloycraft 321	C 0.046 Si 0.57 Mn 1.93 Ni 10.1 Cr 19.63 Mo 0.08 Ti 0.7	1.2-4.0 (L= 1000mm)	DC(-)	420	620	35			
A4219YYDXXS	AWS ER347	Alloycraft 347	C 0.04 Si 0.41 Mn 1.81 Ni 9.9 Cr 20.4 Mo 0.07 Nb 0.5	1.2-4.0 (L= 1000mm)	DC(-)	450	600	40			
A4220YYDXXS	AWS ER410	Alloycraft 410	C 0.11 Si 0.45 Mn 0.43 Ni 0.18 Cr 11.8	1.2-4.0 (L= 1000mm)	DC(-)	340	540	25			
A4221YYDXXS	AWS ER430	Alloycraft 430	C 0.032 Si 0.26 Mn 0.31 Ni 0.15 Cr 16.24 Mo 0.02	1.2-4.0 (L= 1000mm)	DC(-)		480	24			
A4222YYDXXS	AWS ER430LNb	Alloycraft 430LNb	C 0.01 Si 0.48 Mn 0.49 Ni 0.2 Cr 18.5 Nb+Ta 0.50	1.2-4.0 (L= 1000mm)	DC(-)		470	45			
A4223YYDXXS		Alloycraft 304	C 0.055 Si 0.64 Mn 1.37 Ni 8.06 Cr 18.45 Nb+Ta 0.16	1.2-4.0 (L= 1000mm)	DC(-)						

TIG RODS
不锈钢实芯氩弧焊支

COPPER AND ALUMINIUM TIG WELDING RODS

铜及铝实芯氩弧焊支



P/N 产品编号	STANDARD 标准	PRODUCT 产品名称	ANALISI CHIMICA 化学成分	SIZE(mm) 直径	TYPE OF CURRENT 电流属性	TYPICAL MACHANICAL PROPERTIES OF ALL-WELD-METAL 力学性能分析				WELDING POSITIONS 焊接位置	APPROVALS 证书
						Y.P N/mm²	T.S N/mm²	EL. (%)	I.V J		
A4401YYDXXS	AWS ERCuSi-A	Alloycraft B8	Fe 0.25 Si 3.40 Mn 1.00 Sn 0.9 Cu Balance Zn 0.9	1.2-4.0 (L= 1000mm)	AC/DC(+)	Hardness 90	380	50			
A4402YYDXXS	AWS ERCu	Alloycraft B10	Si 0.50 Mn 0.50 P 0.15 Sn 1 Cu 98	1.2-4.0 (L= 1000mm)	AC/DC(+)	Hardness 55	200	30			
P/N 产品编号	STANDARD 标准	PRODUCT 产品名称	ANALISI CHIMICA 化学成分	SIZE(mm) 直径	TYPE OF CURRENT 电流属性	TYPICAL MACHANICAL PROPERTIES OF ALL-WELD-METAL 力学性能分析				POSIZIONI DI SALDATURA 焊接位置	APPROVALS 证书
						Y.P N/mm²	T.S N/mm²	EL. (%)	I.V J		
A4301YYDXXS	AWS ER4043	Alloycraft 4043	Fe 0.80 Si 4.5-6 Mn 0.05 Cu 0.30 Mg 0.05 Zn 0.1 Ti 0.2 Al Balance	1.2-4.0 (L= 1000mm)	AC/DC(+)		110	Melting Point 630°C			
A4302YYDXXS	AWS ER5356	Alloycraft 5356	Fe 0.40 Si 0.25 Mn 0.05-0.20 Cu 0.10 Mg 4.50-5.50 Zn 0.1 Ti 0.05-0.2 Cr 0.05-0.2 Al Balance	1.2-4.0 (L= 1000mm)	AC/DC(+)		270	Melting Point 640°C			
A4304YYDXXS	AWS ER4047	Alloycraft 4047	Fe 0.8 Si 11-13 Mn 0.15 Cu 0.3 Mg 0.1 Zn 0.2 Cr 0.05-0.2 Al Balance	1.2-4.0 (L= 1000mm)	AC/DC(+)		150	Melting Point 580°C			

TIG RODS
氩弧焊支

PACKAGE 包装

TUBE 2.5

Plastica - 塑料

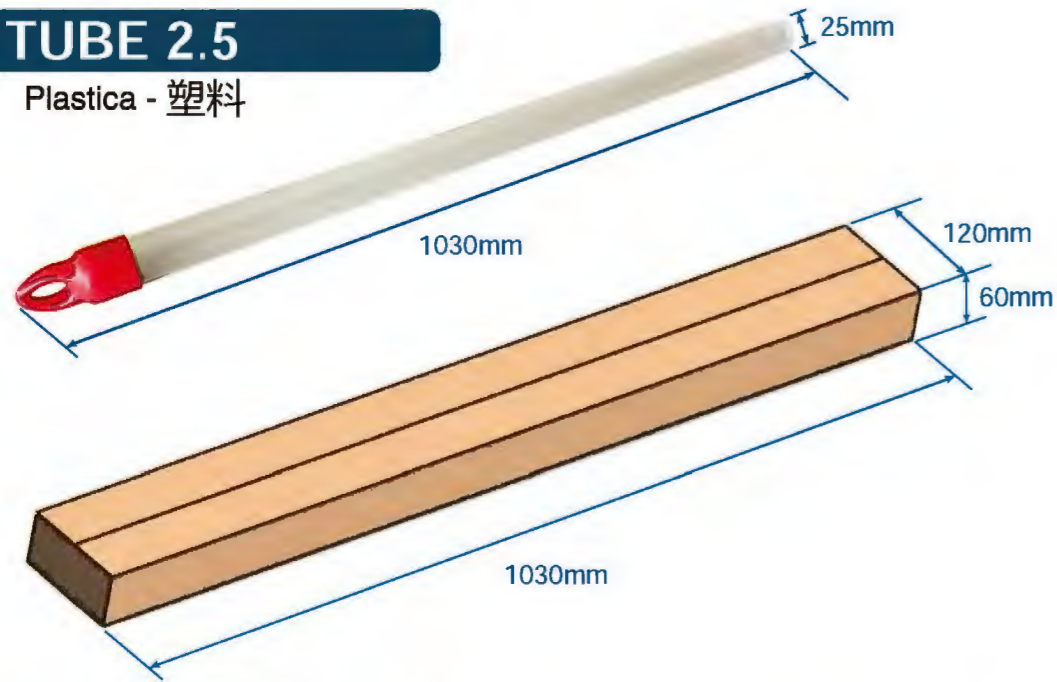

2.5Kg

20Kg

OUTSIDEBOX 外包装

CARTON 5AL



5Kg

20Kg

OUTSIDEBOX 外包装

PACKAGE 包装

TUBE 5S

Plastica - 塑料

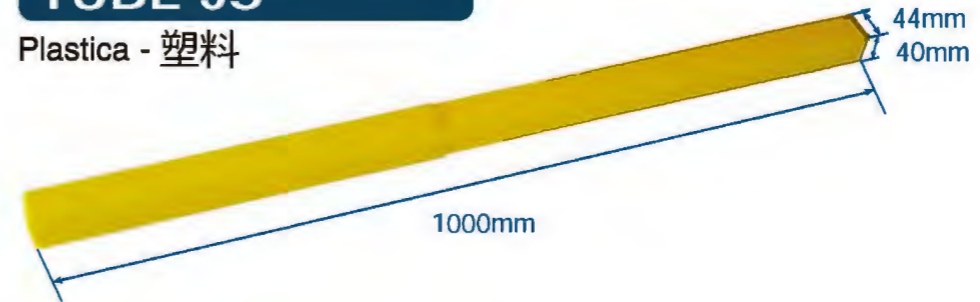

5Kg

TUBE 5

Plastica - 塑料

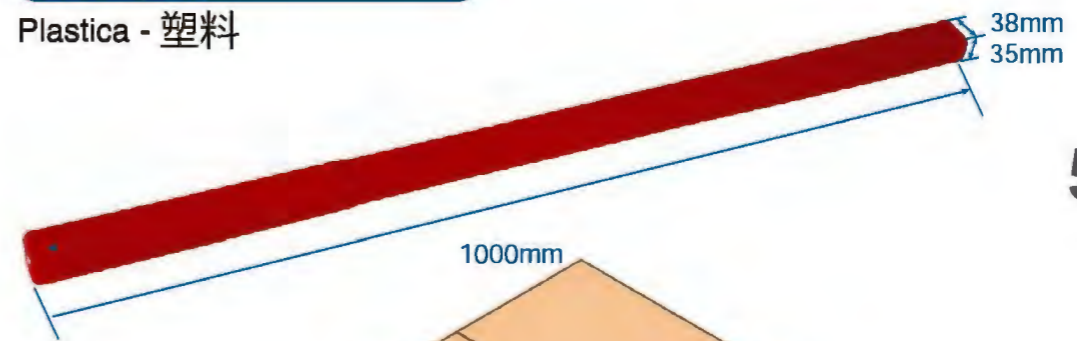

5Kg

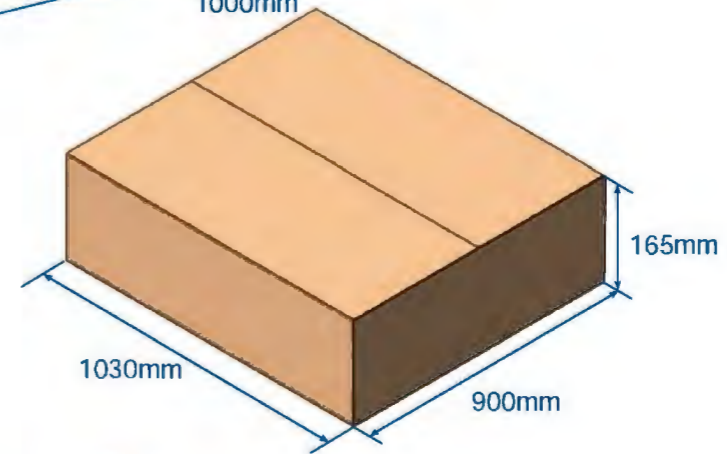

500Kg

OUTSIDEBOX 外包装

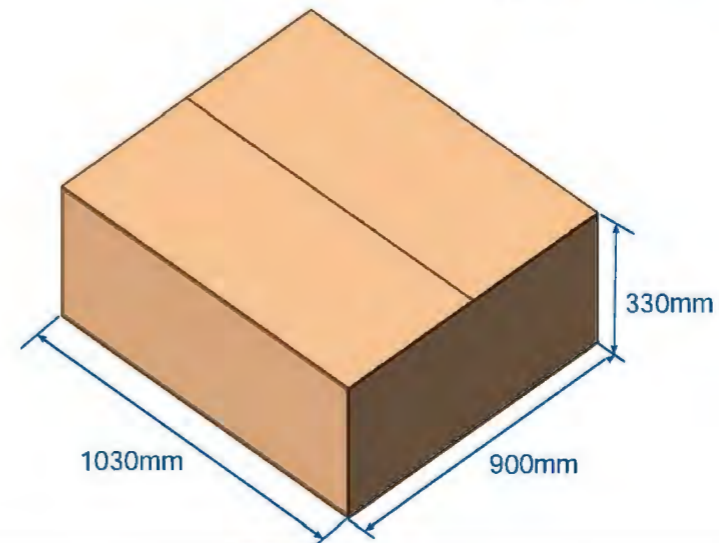

1.000Kg

OUTSIDEBOX 外包装



FLUX CORED WIRES

药芯焊丝

- | | |
|-------|--|
| 66-71 | FLUX CORED WIRES
气体保护药芯焊丝 |
| 72-73 | OPEN ARC FLUX CORED WIRES
自保护药芯焊丝 |
| 74-75 | STAINLESS STEELS FLUX CORED WIRES
不锈钢气体保护药芯焊丝 |
| 76-83 | HARDFACING FLUX CORED WIRE
硬面堆焊气保护药芯焊丝 |
| 84-87 | PACKAGE
包装 |

FLUX CORED ARC WELDING (FCAW) WIRES

气体保护药芯焊丝



P/N 产品编号	STANDARD 标准	PRODUCT 产品名称	ANALISI CHIMICA 化学成分	SIZE(mm) 直径	TYPE OF CURRENT 电流属性	TYPICAL MACHANICAL PROPERTIES OF ALL-WELD-METAL 力学性能分析				WELDING POSITIONS 焊接位置	APPROVALS 证书
						Y.P N/mm ²	T.S N/mm ²	EL. (%)	I.V J		
A5101YYDXXS	AWS E71T-1	Alloycraft 71T-1	C 0.05 Si 0.36 Mn 1.28 S 0.008 P 0.015	1.0-2.4	DC(+)	450	525	32	145(-20°C)		CCS ABS BV DNV GL LR NK
A5102YYDXXS	AWS E71T-1J	Alloycraft 71Ni	C 0.05 Si 0.36 Mn 1.32 P 0.008 S 0.016 Ni 0.45	1.2-1.6	DC(+)	445	530	30	110 (-20°C)		CCS ABS GL
A5103YYDXXS	AWS E70T-1	Alloycraft 70T-1	C 0.05 Si 0.38 Mn 1.50 S 0.01 P 0.015 Cr 0.03 Ni 0.02 Mo 0.05	1.2-2.4	DC(+)	435	525	30	100 (-20°C)		CCS ABS GL
A5104YYDXXS	AWS E81T1-W2C	Alloycraft 81W2	C 0.05 Si 0.38 Mn 1.20 S 0.011 P 0.014 Cr 0.48 Ni 0.5 Cu 0.38	1.2-1.6	DC(+)	550	615	27	105 (-30°C)		
A5105YYDXXS	AWS E81T1-Ni1C	Alloycraft 81Ni1	C 0.05 Si 0.35 Mn 1.33 S 0.009 P 0.012 Ni 0.92 Mo 0.15	1.2-1.6	DC(+)	540	605	26	140 (-30°C)		
A5106YYDXXS	AWS E81T1-Ni2C	Alloycraft 81Ni2	C 0.08 Si 0.45 Mn 1.20 S 0.009 P 0.016 Ni 2.05	1.2-1.6	DC(+)	560	635	25	108 (-40°C)		
A5107YYDXXS	AWS E91T1-K2C	Alloycraft 91K2	C 0.03 Si 0.45 Mn 1.27 S 0.01 P 0.015 Ni 1.45	1.2-1.6	DC(+)	560	660	26	75 (-51°C)		
A5108YYDXXS	AWS E91T1-Ni2C	Alloycraft 91Ni2	C 0.05 Si 0.40 Mn 1.05 S 0.012 P 0.018 Ni 2.12	1.2-1.6	DC(+)	575	660	24	87 (-40°C)		
A5201YYDXXS	AWS E2209T1-1	Alloycraft 2209T1-1	C 0.03 Si 0.40 Mn 1.30 S 0.008 P 0.015 Cr 23.1 Ni 8.9 Mo 3.5 Cu 0.21	1.2-1.6	DC(+)		785	25			

FLUX CORED WIRES
药芯焊丝

FLUX CORED ARC WELDING (FCAW) WIRES

气体保护药芯焊丝



P/N 产品编号	STANDARD 标准	PRODUCT 产品名称	ANALISI CHIMICA 化学成分	SIZE(mm) 直径	TYPE OF CURRENT 电流属性	TYPICAL MACHANICAL PROPERTIES OF ALL-WELD-METAL 力学性能分析				WELDING POSITIONS 焊接位置	APPROVALS 证书
						Y.P N/mm ²	T.S N/mm ²	EL. (%)	I.V J		
A5401YYDXXS	AWS E71T1-1C	Alloycraft SL71T1-1C	C 0.05 Si 0.42 Mn 1.25 S 0.007 P 0.012	1.2-1.6	DC(+)	470	560	28	120 (-20°C)		
A5402YYDXXS	AWS E71T1-1M	Alloycraft SL71T1-1M	C 0.08 Si 0.45 Mn 1.21 S 0.008 P 0.013	1.2-1.6	DC(+)	480	565	29	105 (-20°C)		
A5403YYDXXS	AWS E71T1-1C-J	Alloycraft SL71T1-1C-J	C 0.05 Si 0.42 Mn 1.35 S 0.007 P 0.012 Ni 0.44	1.2-1.6	DC(+)	490	585	28	125 (-40°C)		
A5404YYDXXS	AWS E70T-1C	Alloycraft SL70T-1C	C 0.05 Si 0.55 Mn 1.45 P 0.01 S 0.015	1.2-1.6	DC(+)	490	585	26	100 (-20°C)		
A5405YYDXXS	AWS E70C-6M H4	Alloycraft SL70C-6M-H4	C 0.08 Si 0.56 Mn 1.50 S 0.007 P 0.015 V 0.05	1.2-1.6	DC(+)	485	595	29	120 (-20°C)		
A5406YYDXXS	AWS E71T1-GC	Alloycraft SL71T1-GC	C 0.05 Si 0.45 Mn 1.23 S 0.009 P 0.012 Ni 0.92 Mo 0.06	1.2-1.6	DC(+)	505	590	28	135 (-40°C)		
A5407YYDXXS	AWS E81T1-K2C	Alloycraft SL81T1-K2C	C 0.04 Si 0.38 Mn 1.35 S 0.007 P 0.015 Ni 1.55 Mo 0.05 V 0.05	1.2-1.6	DC(+)		610	28	108 (-60°C)		
A5408YYDXXS	AWS E81T1-Ni1C	Alloycraft SL81T1-Ni1C	C 0.05 Si 0.35 Mn 1.34 S 0.008 P 0.015 Ni 0.95 V 0.05	1.2-1.6	DC(+)	510	615	29	105 (-40°C)		
A5409YYDXXS	AWS E81T1-Ni2C	Alloycraft SL81T1-Ni2C	C 0.045 Si 0.37 Mn 1.37 S 0.007 P 0.015 Ni 2.1	1.2-1.6	DC(+)	540	630	28	126(-40°C)		

FLUX CORED ARC WELDING (FCAW) WIRES
 气体保护药芯焊丝



P/N 产品编号	STANDARD 标准	PRODUCT 产品名称	ANALISI CHIMICA 化学成分	SIZE(mm) 直径	TYPE OF CURRENT 电流属性	TYPICAL MACHANICAL PROPERTIES OF ALL-WELD-METAL 力学性能分析				WELDING POSITIONS 焊接位置	APPROVALS 证书
						Y.P N/mm ²	T.S N/mm ²	EL. (%)	I.V J		
A5410YYDXXS	AWS E110C-K3	Alloycraft SL110C-K3	C 0.06 Si 0.45 Mn 1.60 S 0.008 P 0.015 Ni 2.05 Mo 0.45	1.2-1.6	DC(+)	720	860	22	100 (-50°C)		
A5411YYDXXS	AWS E761T1-K3C	Alloycraft SL761T1-K3C	C 0.05 Si 0.46 Mn 1.46 S 0.007 P 0.015 Ni 2.04 Mo 0.48	1.2-1.6	DC(+)	715	855	20	100 (-20°C)		

STAINLESS STEELS FLUX CORED ARC WELDING WIRES
 不锈钢气体保护药芯焊丝



P/N 产品编号	STANDARD 标准	PRODUCT 产品名称	ANALISI CHIMICA 化学成分	SIZE(mm) 直径	TYPE OF CURRENT 电流属性	TYPICAL MACHANICAL PROPERTIES OF ALL-WELD-METAL 力学性能分析				WELDING POSITIONS 焊接位置	APPROVALS 证书
						Y.P N/mm ²	T.S N/mm ²	EL. (%)	I.V J		
A5202YYDXXS	AWS E308LT1-1	Alloycraft 308LT1-1	C 0.03 Si 0.44 Mn 1.70 P 0.01 S 0.012 Cr 19.6 Ni 9.9 Mo 0.05 Cu 0.2	1.2-1.6	DC(+)		575	40			
A5203YYDXXS	AWS E309LT1-1	Alloycraft 309LT1-1	C 0.03 Si 0.50 Mn 1.65 P 0.012 S 0.015 Cr 19.6 Ni 9.9 Mo 0.05 Cu 0.2	1.2-1.6	DC(+)		565	42			
A5204YYDXXS	AWS E316LT1-1	Alloycraft 316LT1-1	C 0.03 Si 0.50 Mn 1.55 P 0.01 S 0.015	1.2-1.6	DC(+)		535	40			
A5205YYDXXS	AWS EC409	Alloycraft 409Ti	C 0.025 Si 0.60 Mn 0.46 P 0.008 S 0.007	1.2-1.6	DC(+)		550	20			
A5206YYDXXS	AWS EC436	Alloycraft 436Ti	C 0.03 Si 0.35 Mn 0.63 P 0.008 S 0.007	1.2-1.6	DC(+)		477	23			
A5207YYDXXS	AWS EC439	Alloycraft 439Ti	C 0.027 Si 0.38 Mn 0.47 S 0.011 P 0.007	1.2-1.6	DC(+)		501	22			

OPEN ARC FLUX CORED WIRES
自保护药芯焊丝



P/N 产品编号	STANDARD 标准	PRODUCT 产品名称	ANALISI CHIMICA 化学成分	SIZE(mm) 直径	TYPE OF CURRENT 电流属性	TYPICAL MACHANICAL PROPERTIES OF ALL-WELD-METAL 力学性能分析				WELDING POSITIONS 焊接位置	APPROVALS 证书
						Y.P N/mm ²	T.S N/mm ²	EL. (%)	I.V J		
A5301YYDXXS	AWS E71T-GS	Alloycraft 71T-GS	C 0.32 Si 0.35 Mn 0.60 S 0.005 P 0.01 Al 1.43	0.8-1.2	DC(-)	460	530	22			
A5302YYDXXS	AWS E71T-11	Alloycraft 71T-11	C 0.25 Si 0.34 Mn 0.66 S 0.007 P 0.009 Al 1.32	0.8-1.2	DC(-)	440	525	22			

HARDFACING FLUX CORED WIRE

硬面堆焊气保护药芯焊丝



P/N 产品编号	SPECIFICATION 性能	PRODUCT 产品名称	ANALISI CHIMICA 化学成分	SIZE(mm) 直径	TYPE OF CURRENT 电流属性	TYPICAL MACHANICAL PROPERTIES OF ALL-WELD-METAL 力学性能分析						POSITIONS 焊接位置	
						Weld layers	Hardness	Stress relief cracking	Resistance to wear	Resistance to impact	Resistance to viscous abrasion		Machining property
A5501YYDXXS	Metal to Metal Wear	Alloycraft SH-D507	C 0.13 Cr 14.04 Other 1.34	1.2	DC(+)								
A5502YYDXXS	Metal to Metal Wear Cr-Mo steel	Alloycraft SH-D507Mo	C 0.12 Cr 14.27 Ni 1.04 Mo 1.14 W 0.35	1.2-2.8	DC(+)								
A5503YYDXXS	High Mn steel	Alloycraft GM307	C 0.1 Cr 19 Ni 9 Mn 6	1.2-2.8	DC(+)	Multi-layer	As welded HRC is 18-21 and HRC48-52 after work hardening		Excellent	Excellent		Carbide tool, easy to machine	
A5504YYDXXS	Metal to Metal Wear Cr-Mo steel	Alloycraft GM250	C 0.1 Cr 1.5 Mo 0.2 Mn 1.5	1.2-2.8	DC(+)	Multi-layer	HRC23-27		Fair	Good	Good	Excellent with carbide	
A5505YYDXXS	Metal to Metal Wear Cr-Mo steel	Alloycraft GM250	C 0.2 Cr 2 Mo 0.2 Mn 1.5	1.2-2.8	DC(+)	Multi-layer	HRC23-27		Excellent	Good		Excellent	
A5506YYDXXS	Metal to Metal Wear Cr-Mo steel	Alloycraft GM350-S	C 0.2 Cr 2 Mo 0.2 Mn 1.8	1.2-2.8	DC(+)	Multi-layer	HRC23-27		Excellent	Good		Use carbide tool, easy to machine	
A5507YYDXXS	Metal to Metal Wear Cr-Mo steel	Alloycraft Gm450	C 0.4 Cr 2.5 Mo 0.5 Mn 1.5 Fe Balance Si 0.6	1.2-2.8	DC(+)	Multi-layer	HRC23-27		Good	Good		Excellent	
A5512YYDXXS	Metal to Metal Wear Cr-Mo steel	Alloycraft GM600	C 0.6 Cr 7 Mo 0.5 Mn 1.5 Fe Balance Si 0.5	1.2-2.8	DC(+)	Multi-layer	HRC23-27		Excellent	Good		Carbide tool Fair	
A5513YYDXXS	Metal to Metal Wear Tool and Die steel	Alloycraft GMH-12	C 0.4 Cr 6.5 Mo 1.2 W 1.5 V 0.2 Mn 1.5 Fe Balance Si 0.8	1.2-2.8	DC(+)	Three layers	HRC23-27		Excellent	Good		Use carbide tool, easy to machine	

HARDFACING FLUX CORED WIRE

硬面堆焊气保护药芯焊丝



P/N 产品编号	SPECIFICATION 性能	PRODUCT 产品名称	ANALISI CHIMICA 化学成分	SIZE(mm) 直径	TYPE OF CURRENT 电流属性	TYPICAL MACHANICAL PROPERTIES OF ALL-WELD-METAL 力学性能分析						Machining property	POSITIONS 焊接位置
						Weld layers	Hardness	Stress relief cracking	Resistance to wear	Resistance to impact	Resistance to viscous abrasion		
A5514YYDXXS	Metal to Metal Wear	Alloycraft GMM-7	C 0.9 Cr 4.4 Mo 8.5 W 1.9 V 0.4 Mn 0.8 Fe Balance Si 0.5	1.2-1.6	DC(+)	Three layers	HRC61-65	Excellent	Excellent	Good		Grinding with grinding tools	
A5515YYDXXS	Martensitic stainless steel	Alloycraft GM410-G	C 0.1 Cr 13 Mn 0.5 Fe Balance Si 0.4	1.2-1.6	DC(+)	Multi-layer	HRC36-40		Excellent	Good		Carbide tool, excellent machinability	
A5516YYDXXS	Martensitic stainless steel	Alloycraft GM414-G	C 0.1 Cr 13.5 Ni 3.5 Mo 0.5 Mn 1 Fe Balance Si 0.5	1.2-1.6	DC(+)	Multi-layer	HRC36-40		Excellent	Good	Fatigue resistance: Excellent	With tungsten carbide cutting tools good processing properties	

HARDFACING OPEN ARC FLUX CORED WIRE

硬面堆焊自保护药芯焊丝



P/N 产品编号	SPECIFICATION 性能	PRODUCT 产品名称	ANALISI CHIMICA 化学成分	SIZE(mm) 直径	TYPE OF CURRENT 电流属性	TYPICAL MACHANICAL PROPERTIES OF ALL-WELD-METAL 力学性能分析					POSITIONS 焊接位置	
						Weld layers	Hardness	Stress relief cracking	Resistance to wear	Resistance to impact		Machining property
A5601YYDXXS	Chromium carbide	Alloycraft GM100	C 3 Cr 15 Mn 1.5 Si 1 Others ≤0.5 Fe Balance	1.2-3.2	DC(+)	Multi-layer	HRC44-48	Some	Good	Good	Use carbide tool,good machining property	
A5602YYDXXS	Chromium carbide	Alloycraft GM101	C 5 Cr 27 Mn 1.5 Si 1 Others ≤0.5 Fe Balance	1.6-3.2	DC(+)	Multi-layer	HRC58-62	Yes	Excellent	Fair	Poor,grinding only	
A5603YYDXXS	Complex carbide	Alloycraft GM901	C 5 Cr 22 Mn 2 Si 1.5 Others ≤0.5 Fe Balance	1.6-3.2	DC(+)	Multi-layer	HRC60-64	Yes	Excellent	Fair	Poor,grinding only	
A5604YYDXXS	Complex carbide	Alloycraft GM902	C 5 Cr 22 Mn 0.5 Si 1 Nb 7 V 0.5 Fe Balance	1.6-3.2	DC(+)	Multi-layer	HRC61-65	Yes	Excellent	Fair	Poor,grinding only	
A5605YYDXXS	Complex carbide	Alloycraft GMKZ-1	C 5.1 Cr 25 Mn 2 Si 1 Nb 3.5 Mo 1.5 Fe Balance	1.2-3.2	DC(+)	3 layer max	HRC61-65	Yes	Excellent	Fair	Poor,grinding only	
A5606YYDXXS	Complex carbide	Alloycraft Gm904	C 5 Cr 22 Mn 0.5 Si 1 V 10 Fe Balance	1.2-3.2	DC(+)	Multi-layer	HRC61-65	Yes	Excellent	Fair	Poor,grinding only	
A5607YYDXXS	Complex carbide	Alloycraft Gm905	C 2 Cr 7 Mn 1 Si 0.5 V 0.2 Fe Balance	1.2-3.2	DC(+)	Multi-layer	HRC53-57	Yes	Excellent	Good	Poor,grinding only	
A5608YYDXXS	High Mn steel	Alloycraft Gm110	C 0.8 Cr 4 Mn 14 Si 0.5 Ni 1.0 Fe Balance	1.2-2.8	DC(+)	Multi-layer	HRC48-52 Original state after welding HRC18-21 and HRC48-52 after work hardening	None	Excellent	Excellent	Carbide cutting tools,easy to machine	
A5609YYDXXS	High Mn steel	Alloycraft Gm120	C 0.3 Cr 14 Mn 15 Si 0.5 Fe Balance	1.6-3.2	DC(+)	Multi-layer	HRC48-52 Original state after welding HRC18-21 and HRC48-52 after work hardening	None	Excellent	Excellent	Carbide cutting tools,easy to machine	

FLUX CORED WIRES
药芯焊丝

HARDFACING OPEN ARC FLUX CORED WIRE

硬面堆焊自保护药芯焊丝



P/N 产品编号	SPECIFICATION 性能	PRODUCT 产品名称	ANALISI CHIMICA 化学成分	SIZE(mm) 直径	TYPE OF CURRENT 电流属性	TYPICAL MACHANICAL PROPERTIES OF ALL-WELD-METAL 力学性能分析					POSITIONS 焊接位置	
						Weld layers	Hardness	Stress relief cracking	Resistance to wear	Resistance to impact		Machining property
A5610YYDXXS	Martensitic stainless steel	Alloycraft GM414-O	C 0.1 Cr 13 Mn 0.5 Si 0.4 Fe Balance	1.2-1.6	DC(+)	Multi-layer	HRC48-52 Original state after welding HRC18-21 and HRC48-52 after work hardening	None	Excellent	Excellent	Tungsten carbide tool, good machinability	
A5611YYDXXS	Martensitic stainless steel	Alloycraft GM414N-O	C 5 Cr 27 Mn 1.5 Si 1 Others ≤0.5 Fe Balance	1.2-1.6	DC(+)	Multi-layer	HRC36-40	None	Excellent	Good	With tungsten carbide cutting tools good processing properties	
P/N 产品编号	SPECIFICATION 性能	PRODUCT 产品名称	TYPICAL CHEMICAL COMPOSITION OF ALL-WELD-METAL(%) 化学成分	SIZE(mm) 直径	TYPE OF CURRENT 电流属性	TYPICAL MACHANICAL PROPERTIES OF ALL-WELD-METAL 力学性能分析					POSIZIONI DI SALDATURA 焊接位置	
						Weld layers	Hardness	Stress relief cracking	Resistance to wear	Resistance to impact	Machining property	
A5612YYDXXS	Tungsten carbide	Alloycraft GM130	Tungsten carbide particles distribute in the steel matrix WC45-60% depending on diameter.	1.6-3.2	DC(+)	Two layers	HRC53-57	Yes	Excellent	Fair	Poor	
A5613YYDXXS	Tungsten carbide	Alloycraft GM130SS	Tungsten carbide particles distribute in the steel matrix WC45-61% depending on diameter.	1.6-3.2	DC(+)	Two layers	HRC58-62	Yes	Excellent	Fair	Poor	
A5614YYDXXS	Tungsten carbide	Alloycraft GM130Ni	Tungsten carbide particles distribute in the steel matrix WC45-62% depending on diameter.	1.6-3.2	DC(+)	Two layers	HRC53-57	Yes	Excellent	Fair	Poor	
A5615YYDXXS	Tungsten carbide	Alloycraft GM130NiP	Tungsten carbide particles distribute in the steel matrix WC45-63% depending on diameter.	1.6-3.2	DC(+)	Two layers	HRC53-57	Yes	Excellent	Fair	Poor	

PACKAGE 包装

D 100

Plastica - 塑料

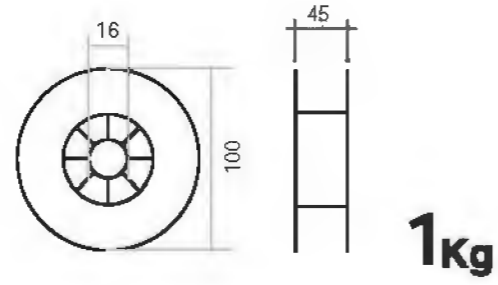

1Kg

D 200

Plastica - 塑料

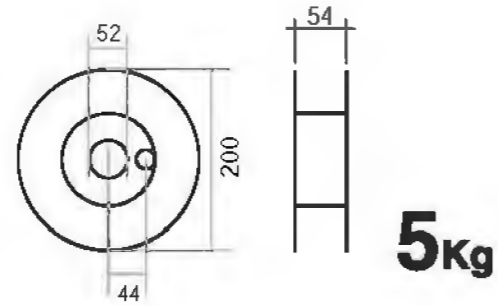

5Kg

D 250

Plastica - 塑料

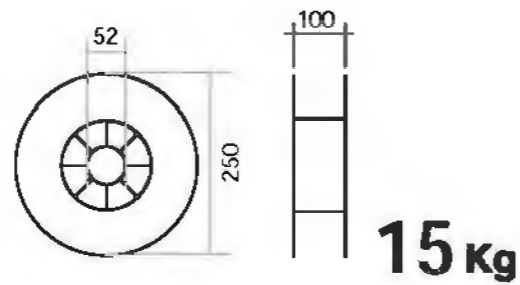

15Kg

PACKAGE 包装

TAYOR

D 270

Plastica - 塑料

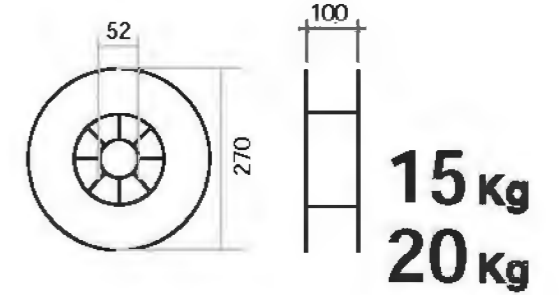

15 Kg
20 Kg

D 300

Plastica - 塑料

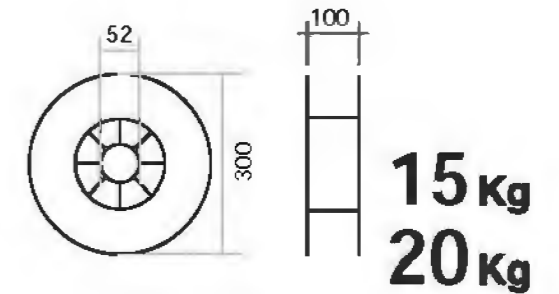

15 Kg
20 Kg

D 300W

Plastica - 塑料

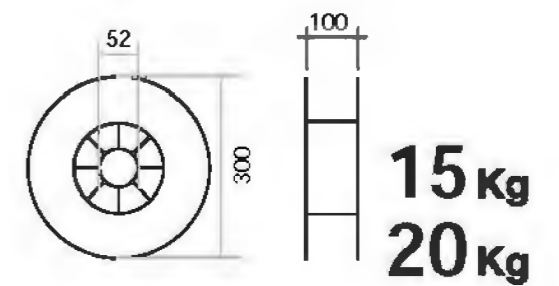

15 Kg
20 Kg

PACKAGE 包装

K 300S

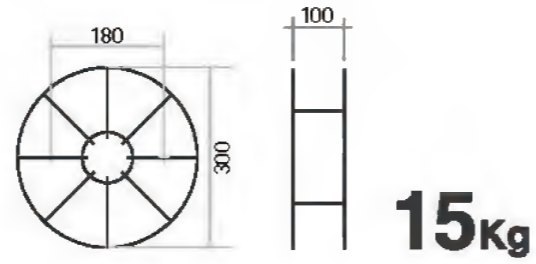
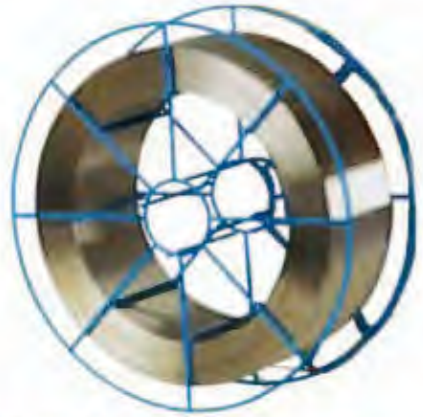

15Kg

K 300

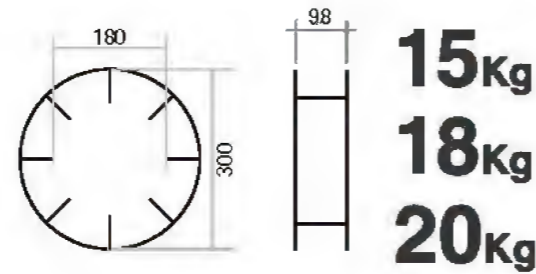

15Kg
18Kg
20Kg

D ADAPTOR



PACKAGE 包装

DRUM 100

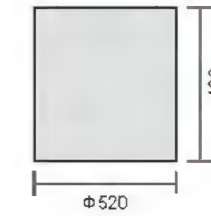

100 Kg

DRUM 250

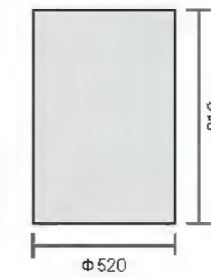

250 Kg

DRUM 300



300 Kg

SUB ARC WIRE AND FLUX 埋弧焊丝及药粉

- 90-97 SUBMERGED ARC WIRE AND FLUX
碳钢埋弧焊丝及药粉
- 98-99 PACKAGE
包装



SUBMERGED ARC WIRE AND FLUX
 镀铜埋弧焊丝及药粉



P/N 产品编号	STANDARD 标准	PRODUCT 产品名称	ANALISI CHIMICA 化学成分	SIZE(mm) 直径	TYPE OF CURRENT 电流属性	TYPICAL MACHANICAL PROPERTIES OF ALL-WELD-METAL 力学性能分析				WELDING POSITIONS 焊接位置	APPROVALS 证书
						Y.P N/mm ²	T.S N/mm ²	EL. (%)	I.V J		
A3701YYDXXS	EH14(H10Mn2)	Alloycraft EH14	C 0.07 Si 0.06 Mn 1.82 S 0.006 p 0.014 Cu 0.04	2.4-4.8	AC/DC(+)						
A3702YYDXXS	EL8(H08A)	Alloycraft EL8	C 0.06 Si 0.02 Mn 0.42 S 0.008	2.4-4.8	AC/DC(+)						
A3703YYDXXS	EM12K(H08MnA)	Alloycraft EM12K	C 0.09 Si 0.28 Mn 1 S 0.01	2.4-4.8	AC/DC(+)						
A3704YYDXXS	EM12(H08MnA)	Alloycraft EM12	C 0.07 Si 0.77 Mn 0.95 S 0.005	2.4-4.8	AC/DC(+)						
A3705YYDXXS	EM13K(H10MnSi)	Alloycraft EM13K	C 0.07 Si 0.77 Mn 0.96 S 0.009	2.4-4.8	AC/DC(+)						

SUBMERGED ARC WIRE AND FLUX
 镀铜埋弧焊丝及药粉

P/N 产品编号	STANDARD 标准	PRODUCT 产品名称	BASICITY INDEX	GRAIN SIZE 直径	TYPE OF CURRENT 电流属性	DENSITY 密度	WELDING POSITIONS 焊接位置	APPROVALS 证书
A3804YYDXXS	F7A4-EH14 F7A2-EM12K F6A0-EL8	Alloycraft Flux 101	1.4	10-40mesh	AC(+)	1.2-1.25/cm3		
A3805YYDXXS	F7A4-EH14 F7A2-EM12K	Alloycraft Flux 101G	1.6	10-40mesh	AC(+)	1.2-1.25/cm3		
A3806YYDXXS	F7A2-EH14	Alloycraft Flux 101Q	2.0	10-40mesh	AC(+)	1.3g/cm3		
A3807YYDXXS	F7A2-EM13K	Alloycraft Flux 101A	1.1	10-40mesh	AC(+)	1.4g/cm3		
A3808YYDXXS	A5.23M F55A2-EA4-A2	Alloycraft Flux 103	2.8	10-40mesh	AC(+)	1.2-1.25/cm3		
A3809YYDXXS	F5A0-EM12K	Alloycraft Flux 301	0.8	10-40mesh	AC(+)	1.23g/cm3		
A3810YYDXXS	F7A2-EM12K	Alloycraft Flux 301T	1.1	10-40mesh	AC(+)	1.25g/cm3		
A3811YYDXXS	F6A0-EM12K	Alloycraft Flux 301X	0.9	10-40mesh	AC(+)	1.23g/cm3		
A3812YYDXXS	F7A2-EM13K	Alloycraft Flux 303	0.8	10-50mesh	AC(+)	1.2-1.25/cm3		

SUBMERGED ARC WIRE AND FLUX
 镀铜埋弧焊丝及药粉



P/N 产品编号	STANDARD 标准	PRODUCT 产品名称	BASICITY INDEX	GRAIN SIZE 直径	TYPE OF CURRENT 电流属性	DENSITY 密度	POSIZIONI DI SALDATURA 焊接位置	APPROVALS 证书
A3813YYDXXS	F7A0-EL12	Alloycraft Flux 501	0.7		AC(+)	1.4g/cm3		
A3814YYDXXS	F7A2-EM13/12/14K F7A4-EM14K	Alloycraft Flux 501A	1.1		AC(+)	1.4g/cm3		
A3815YYDXXS	F7A0-EM13K F7A0-EL12 F7A2-EM12K	Alloycraft Flux 501T	0.7		AC(+)	1.4g/cm3		
A3816YYDXXS		Alloycraft Flux 601	1.8		AC(+)	1.2-1.25/cm3		
A3817YYDXXS		Alloycraft Flux 102D	2.4		AC(+)	1.2-1.25/cm3		
A3818YYDXXS	F6A0-EM12K	Alloycraft Flux 201	1.3		AC(+)	1.2-1.25/cm3		
A3819YYDXXS	F6A2-EM12K	Alloycraft Flux 401	0.7		AC(+)	1.2g/cm3		

SUBMERGED ARC WIRE AND FLUX
 镀铜埋弧焊丝及药粉



P/N 产品编号	SPECIFICATION 性能	PRODUCT 产品名称	ANALISI CHIMICA 化学成分	SIZE(mm) 直径	TYPE OF CURRENT 电流属性	TYPICAL MACHANICAL PROPERTIES OF ALL-WELD-METAL 力学性能分析					Machining property	POSIZIONI DI SALDATURA 焊接位置
						Weld layers	Hardness	Stress relief cracking	Resistance to wear	Resistance to impact		
A3807YYDS	Metal to Metal Wear Tool and Die steel	Alloycraft GMH12-S	C 0.4 Si 0.8 Mn 1.5 W 1.5 V 0.2 Fe Balance Cr 6.5 Mo 1.2	2.4-3.2	DC(+)	Three layers	HRC51-55	None	Excellent	Good	Use boron nitride tool,good	
A3808YYDS	Martensitic stainless steel	Alloycraft GM414-S	C 0.12 Si 0.5 Mn 1.2 Fe Balance Cr 13	2.4-3.2	DC(+)	Multi-layer	HRC43-47	None	Excellent	Good	With tungsten carbide cutting tools good processing properties	
A3809YYDS	Martensitic stainless steel	Alloycraft GM420-S	C 0.25 Si 0.6 Mn 0.8 Fe Balance Cr 13	2.4-3.2	DC(+)	Multi-layer	HRC48-52	None	Excellent	Good	With tungsten carbide cutting tools good processing properties	

P/N 产品编号	STANDARD 标准	PRODUCT 产品名称	ANALISI CHIMICA 化学成分	SIZE(mm) 直径	TYPICAL MACHANICAL PROPERTIES OF ALL-WELD-METAL 力学性能分析				POSIZIONI DI SALDATURA 焊接位置	APPROVALS 证书
					Y.P N/mm ²	T.S N/mm ²	EL. (%)	I.V J		
A3801YYDS	EL8+Flux A	Alloycraft Flux A	C 0.06 Si 0.5 Mn 1.14 S 0.014 P 0.026			400	495	32	68(-18°C)	
A3802YYDS	EM12K+Flux N	Alloycraft Flux N	C 0.08 Si 0.45 Mn 1.55 S 0.011 P 0.022			450	555	30	70(-30°C)	
A3803YYDS	EH14+Flux B	Alloycraft Flux B	C 0.09 Si 0.39 Mn 1.63 S 0.015 P 0.024			470	575	29	84(-40°C)	

PACKAGE 包装

K 415

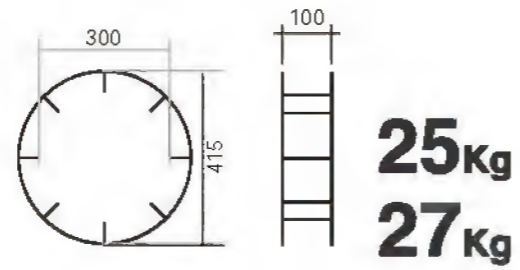

D 415

Plastica - 塑料

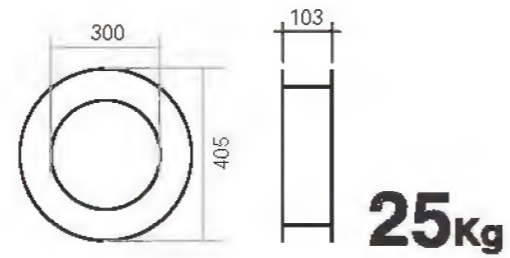

C 415

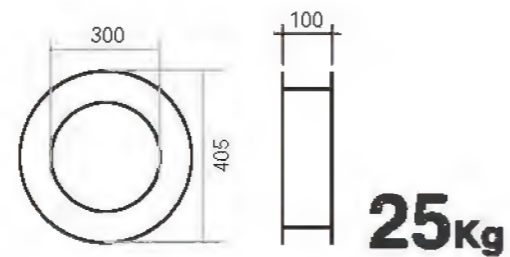

PACKAGE 包装

BAG 25 FLUX



25Kg

DRUM 250FUX

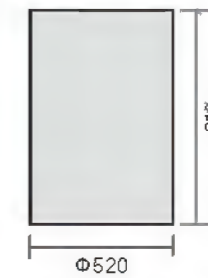

250Kg

PACKAGE 包装

D 100

Plastica - 塑料

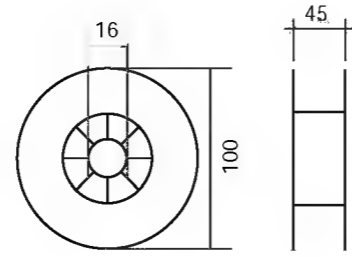

1Kg

D 200

Plastica - 塑料

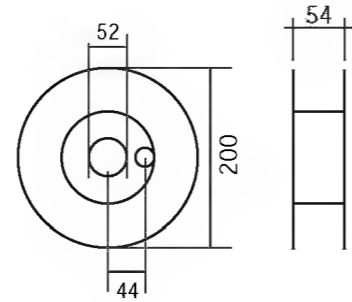

5Kg

D 250

Plastica - 塑料

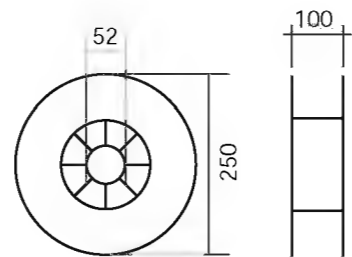

15Kg

PACKAGE 包装

TAYOR

D 270

Plastica - 塑料

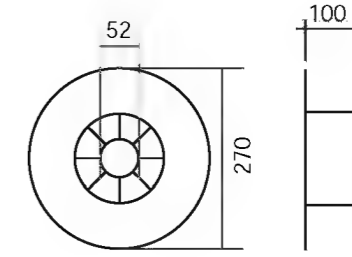

15Kg
20Kg

D 300

Plastica - 塑料

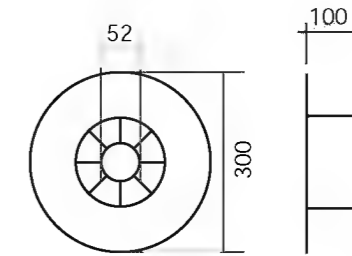

15Kg
20Kg

D 300W

Plastica - 塑料

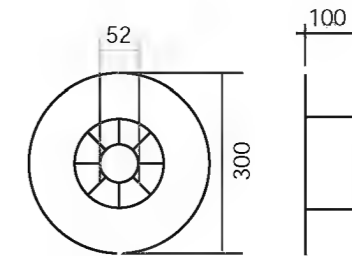

15Kg
20Kg

PACKAGE 包装

K 415

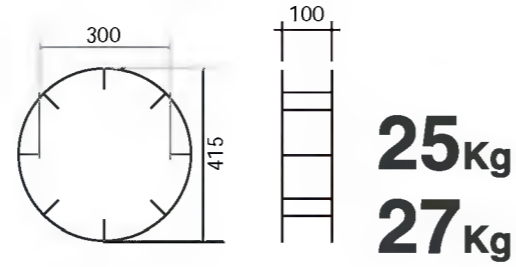

D 415

Plastica - 塑料

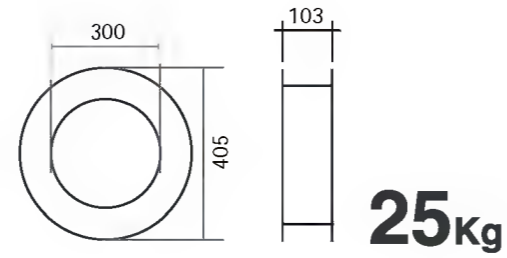

C 415

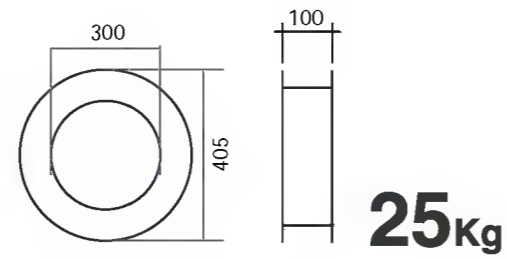

PACKAGE 包装

BAG 25 FLUX



25Kg

DRUM 250FUX

